

NOTICE!!

These documents have been scanned!

Do not place un-scanned documents beneath this notice!

Do not remove this notice from this file!

GPO Jacket No. 560-102
Print Order 61540
Rise Business Services, LLC
Job=AZ15 5/22/2019



Box Number= AZ15079



Claim Begin-End: AMC394513-AMC394513

1 Initial Receipt



AZ15079-5

AMC394407-AMC394878

United States Department of the Interior

Bureau of Land Management
 BUSINESS & SUPPORT SVCS DIV
 ONE N CENTRAL AVE SUITE 800
 PHOENIX, AZ 85004 -4427
 Phone: (602) 417-9200

Receipt

No: 1769643

Transaction #: 1827324		ENTERED INTO COMPUTER AUG 26 2008 <i>FB</i>
Date of Transaction: 08/25/2008		
CUSTOMER:	CWILLIAM NICHOLS 26134 N 93RD AVE PEORIA, AZ 85383	

LINE #	QTY	DESCRIPTION	REMARKS	UNIT PRICE	TOTAL
1	1.00	LOCATABLE MINERALS / MINING CLAIMS- NEW, UNADJUD, ONE OR MORE AUTH NOS / NEW MINING CLAIM PROCESSING FEE \$15 (1930) CASES: AMC394513/\$15.00		- n/a -	15.00
2	1.00	LOCATABLE MINERALS / MINING CLAIMS- NEW, UNADJUD, ONE OR MORE AUTH NOS / NEW MINING CLAIM LOCATION FEE \$30 (1993) CASES: AMC394513/\$30.00		- n/a -	30.00
3	1.00	LOCATABLE MINERALS / MINING CLAIMS- NEW, UNADJUD, ONE OR MORE AUTH NOS / NEW MINING CLM MAINT FEE \$125 (1993) CASES: AMC394513/\$125.00		- n/a -	125.00
4	1.00	LOCATABLE MINERALS / MINING CLAIMS- NEW, UNADJUD, ONE OR MORE AUTH NOS / NEW MINING CLM MAINT FEE \$125 (1993) CASES: AMC394513/\$125.00	<i>2009</i>	- n/a -	125.00
TOTAL:					\$295.00

PAYMENT INFORMATION			
NOTE: Items will appear on credit card statement as "Bureau of Land Mgmt CO".			
1	AMOUNT:	\$295.00	POSTMARKED: N/A
	TYPE:	CREDIT CARD	RECEIVED: 08/25/2008
	NAME:	NICHOLS, CWILLIAM 26134 N 93RD AVE PEORIA AZ 85383	
	CARD NO:	XXXXXXXXXXXX2024	AUTH CODE: 091918
	NAME ON CARD:	JOSEPH C HULL PLLC	
	EXPIRES:	01/31/2010	
	SIGNATURE:		

REMARKS

This receipt was generated by the automated BLM Collections and Billing System and is a paper representation of a portion of the official electronic record contained therein.

NOTICE!!

These documents have been scanned!

Do not place un-scanned documents beneath this notice!

Do not remove this notice from this file!

GPO Jacket No. 560-102
Print Order 61540
Rise Business Services, LLC
Job=AZ15 5/22/2019



Box Number= AZ15079



Claim Begin-End: AMC394513-AMC394513

2 Correspondence



AZ15079-5

AMC394407-AMC394878

**NO
DOCUMENTS
FOUND**

NO DOCUMENTS FOUND
NO DOCUMENTS FOUND

NOTICE!!

These documents have been scanned!

Do not place un-scanned documents beneath this notice!

Do not remove this notice from this file!

GPO Jacket No. 560-102
Print Order 61540
Rise Business Services, LLC
Job=AZ15 5/22/2019



Box Number= AZ15079



Claim Begin-End: AMC394513-AMC394513

3 Transfers



AZ15079-5

AMC394407-AMC394878

**NO
DOCUMENTS
FOUND**

NO DOCUMENTS FOUND
NO DOCUMENTS FOUND

NOTICE!!

These documents have been scanned!

Do not place un-scanned documents beneath this notice!

Do not remove this notice from this file!

GPO Jacket No. 560-102
Print Order 61540
Rise Business Services, LLC
Job=AZ15 5/22/2019



Box Number= AZ15079



Claim Begin-End: AMC394513-AMC394513

4 Annual Filings



AZ15079-5

AMC394407-AMC394878

UNITED STATES
DEPARTMENT OF THE INTERIOR
BUREAU OF LAND MANAGEMENT
MAINTENANCE FEE PAYMENT FORM
FOR PLACER MINING CLAIMS

445346
410302
396392 384793
396284 ~~396284~~
397074 403058
398944 394491
403665 394051
398962 394513
439917

Remitter Name: C William & Marcelline J Nichols
Mailing Address: 26134 N. 93rd Ave.
City, State, Zip: Pecora, AZ 85383

Check here if this is a change of address.

FOR COUNTY RECORDER'S USE

No. of claims 9
Total due BLM \$ 2790.00

- The maintenance fee may be paid by cash, check, money order, Bureau of Land Management (BLM) Declining Deposit Account, or credit card (VISA, American Express, Discover, or MasterCard). Payments must be remitted to the BLM State Office where your claim or site is recorded and received on or before September 1. If the payment is mailed, the envelope must be postmarked by a bona fide delivery service on or before September 1 and received at the proper BLM State Office within 15 calendar days after the due date. Payments may also be made by telephone using a credit card. A complete listing of BLM State Offices with their addresses and phone numbers can be found at <http://www.blm.gov>.
- The maintenance fee for the following claim(s) applies to the assessment year 2019

CLAIM NAME	BLM SERIAL NO.	ACRES IN CLAIM	PAYMENT DUE TO THE BLM (See Instructions on Page 2)
Red Picacho #1	AMC 445346	40	310.00
Red Picacho #2	AMC 445347	40	310.00
Red Picacho #3	AMC 445348	40	310.00
Red Picacho #4	AMC 445349	40	310.00
Red Picacho #5	AMC 445350	40	310.00
Red Picacho #6	AMC 445351	40	310.00
Red Picacho #7	AMC 445352	40	310.00
Red Picacho #8	AMC 445353	40	310.00
Red Picacho #9	AMC 445354	40	310.00

RECEIVED
BLM AZ STATE OFFICE
SEP 17 2018
PHENIX, ARIZONA

Use a separate sheet for additional claim names, serial numbers, and claimant names and addresses.

4260122

ENTERED
SEP 17 2018
BY: RAM

UNITED STATES
DEPARTMENT OF THE INTERIOR
BUREAU OF LAND MANAGEMENT
**MAINTENANCE FEE PAYMENT FORM
FOR PLACER MINING CLAIMS**

Remitter Name: C. William +
Marcelline J. Nichols
Mailing Address: 26134 N. 93rd Ave.
City, State, Zip: Peoria, AZ 85383

Check here if this is a change of address.

FOR COUNTY RECORDER'S USE

No. of claims 10
Total due BLM \$ 3100.00

1. The maintenance fee may be paid by cash, check, money order, Bureau of Land Management (BLM) Declining Deposit Account, or credit card (VISA, American Express, Discover, or MasterCard). Payments must be remitted to the BLM State Office where your claim or site is recorded and received on or before September 1. If the payment is mailed, the envelope must be postmarked by a bona fide delivery service on or before September 1 and received at the proper BLM State Office within 15 calendar days after the due date. Payments may also be made by telephone using a credit card. A complete listing of BLM State Offices with their addresses and phone numbers can be found at <http://www.blm.gov>.

2. The maintenance fee for the following claim(s) applies to the assessment year 2019

CLAIM NAME	BLM SERIAL NO.	ACRES IN CLAIM	PAYMENT DUE TO THE BLM (See Instructions on Page 2)
<u>Cordes Peak #1</u>	<u>AMC 410303</u>	<u>40</u>	<u>310.00</u>
<u>Cordes Peak #2</u>	<u>AMC 410304</u>	<u>40</u>	<u>310.00</u>
<u>Estrella #1</u>	<u>AMC 384793</u>	<u>40</u>	<u>310.00</u>
<u>Estrella #2</u>	<u>AMC 384794</u>	<u>40</u>	<u>310.00</u>
<u>Estrella #3</u>	<u>AMC 384795</u>	<u>40</u>	<u>310.00</u>
<u>Estrella #4</u>	<u>AMC 384796</u>	<u>40</u>	<u>310.00</u>
<u>Hila Mountain #1</u>	<u>AMC 403058</u>	<u>40</u>	<u>310.00</u>
<u>Hila Mountain #2</u>	<u>AMC 403059</u>	<u>40</u>	<u>310.00</u>
<u>Hila Mountain #3</u>	<u>AMC 403060</u>	<u>40</u>	<u>310.00</u>
<u>Hila Mountain #4</u>	<u>AMC 403061</u>	<u>40</u>	<u>310.00</u>

RECEIVED
 BLM STATE OFFICE
 PHOENIX, ARIZONA
 2019 SEP 01
 310.00

Use a separate sheet for additional claim names, serial numbers, and claimant names and addresses.

UNITED STATES
DEPARTMENT OF THE INTERIOR
BUREAU OF LAND MANAGEMENT
**MAINTENANCE FEE PAYMENT FORM
FOR PLACER MINING CLAIMS**

Remitter Name: C William +
Marilline J Nichols
Mailing Address: 26134 N. 93rd Ave.
City, State, Zip: Peoria, AZ 85383

Check here if this is a change of address.

FOR COUNTY RECORDER'S USE

No. of claims 10
Total due BLM \$ 3100⁰⁰

- The maintenance fee may be paid by cash, check, money order, Bureau of Land Management (BLM) Declining Deposit Account, or credit card (VISA, American Express, Discover, or MasterCard). Payments must be remitted to the BLM State Office where your claim or site is recorded and received on or before September 1. If the payment is mailed, the envelope must be postmarked by a bona fide delivery service on or before September 1 and received at the proper BLM State Office within 15 calendar days after the due date. Payments may also be made by telephone using a credit card. A complete listing of BLM State Offices with their addresses and phone numbers can be found at <http://www.blm.gov>.
- The maintenance fee for the following claim(s) applies to the assessment year 2019.

CLAIM NAME	BLM SERIAL NO.	ACRES IN CLAIM	PAYMENT DUE TO THE BLM (See Instructions on Page 2)
<u>Sila Mountain #6</u>	<u>AMC 384797</u>	<u>40</u>	<u>310⁰⁰</u>
<u>Sila Mountain #7</u>	<u>AMC 384798</u>	<u>40</u>	<u>310⁰⁰</u>
<u>Sila Mountain #8</u>	<u>AMC 384799</u>	<u>40</u>	<u>310⁰⁰</u>
<u>Sila Mountain #9</u>	<u>AMC 384800</u>	<u>40</u>	<u>310⁰⁰</u>
<u>Sila Mountain #10</u>	<u>AMC 384801</u>	<u>40</u>	<u>310⁰⁰</u>
<u>Sila Mountain #11</u>	<u>AMC 384802</u>	<u>40</u>	<u>310⁰⁰</u>
<u>Sila Mountain #12</u>	<u>AMC 384803</u>	<u>40</u>	<u>310⁰⁰</u>
<u>Sila Mountain #13</u>	<u>AMC 384804</u>	<u>40</u>	<u>310⁰⁰</u>
<u>Sila Mountain #14</u>	<u>AMC 384805</u>	<u>40</u>	<u>310⁰⁰</u>
<u>Sila Mountain #15</u>	<u>AMC 384806</u>	<u>40</u>	<u>310⁰⁰</u>

PHOENIX, ARIZONA RECEIVED BY STATE OFFICE

Use a separate sheet for additional claim names, serial numbers, and claimant names and addresses.

UNITED STATES
DEPARTMENT OF THE INTERIOR
BUREAU OF LAND MANAGEMENT
**MAINTENANCE FEE PAYMENT FORM
FOR PLACER MINING CLAIMS**

Remitter Name: C. William +
Marilline J Nichols

Mailing Address: 26134 N. 93rd Ave.

City, State, Zip: Peoria, AZ 85383

Check here if this is a change of address.

FOR COUNTY RECORDER'S USE

No. of claims 10
Total due BLM \$ 3100⁰⁰

- The maintenance fee may be paid by cash, check, money order, Bureau of Land Management (BLM) Declining Deposit Account, or credit card (VISA, American Express, Discover, or MasterCard). Payments must be remitted to the BLM State Office where your claim or site is recorded and received on or before September 1. If the payment is mailed, the envelope must be postmarked by a bona fide delivery service on or before September 1 and received at the proper BLM State Office within 15 calendar days after the due date. Payments may also be made by telephone using a credit card. A complete listing of BLM State Offices with their addresses and phone numbers can be found at <http://www.blm.gov>.
- The maintenance fee for the following claim(s) applies to the assessment year 2019.

CLAIM NAME	BLM SERIAL NO.	ACRES IN CLAIM	PAYMENT DUE TO THE BLM (See Instructions on Page 2)
<u>Hila Mountain #16</u>	<u>AMC 384807</u>	<u>40</u>	<u>310⁰⁰</u>
<u>Hila Mountain #17</u>	<u>AMC 384808</u>	<u>40</u>	PHOENIX, ARIZONA RECEIVED BY BLM STATE OFFICE
<u>Hila Mountain #18</u>	<u>AMC 394491</u>	<u>40</u>	
<u>Hila Mountain #19</u>	<u>AMC 394492</u>	<u>40</u>	
<u>Hila Mountain #20</u>	<u>AMC 394493</u>	<u>40</u>	
<u>Hila Mountain #21</u>	<u>AMC 394494</u>	<u>40</u>	
<u>Hila Mountain #22</u>	<u>AMC 394495</u>	<u>40</u>	
<u>Hila Mountain #23</u>	<u>AMC 394496</u>	<u>40</u>	
<u>Hila Mountain #24</u>	<u>AMC 394497</u>	<u>40</u>	
<u>Hila Mountain #25</u>	<u>AMC 394498</u>	<u>40</u>	

Use a separate sheet for additional claim names, serial numbers, and claimant names and addresses.

UNITED STATES
DEPARTMENT OF THE INTERIOR
BUREAU OF LAND MANAGEMENT
**MAINTENANCE FEE PAYMENT FORM
FOR PLACER MINING CLAIMS**

Remitter Name: William & Masulline J. Nichols
 Mailing Address: 26134 N. 93rd Ave.
 City, State, Zip: Peoria, AZ 85383

Check here if this is a change of address.

FOR COUNTY RECORDER'S USE

No. of claims 10
 Total due BLM \$ 3100.00

- The maintenance fee may be paid by cash, check, money order, Bureau of Land Management (BLM) Declining Deposit Account, or credit card (VISA, American Express, Discover, or MasterCard). Payments must be remitted to the BLM State Office where your claim or site is recorded and received on or before September 1. If the payment is mailed, the envelope must be postmarked by a bona fide delivery service on or before September 1 and received at the proper BLM State Office within 15 calendar days after the due date. Payments may also be made by telephone using a credit card. A complete listing of BLM State Offices with their addresses and phone numbers can be found at <http://www.blm.gov>.
- The maintenance fee for the following claim(s) applies to the assessment year 2018.

CLAIM NAME	BLM SERIAL NO.	ACRES IN CLAIM	PAYMENT DUE TO THE BLM (See Instructions on Page 2)
Sila Mountain #26	AMC 394499	40	310.00
Sila Mountain #27	AMC 394500	40	310.00
Sila Mountain #28	AMC 394501	40	310.00
Sila Mountain #29	AMC 394502	40	310.00
Sila Mountain #30	AMC 394503	40	310.00
Sila Mountain #31	AMC 394504	40	310.00
Sila Mountain #32	AMC 394505	40	310.00
Sila Mountain #33	AMC 394506	40	310.00
Sila Mountain #34	AMC 394507	40	310.00
Sila Mountain #35	AMC 394508	40	310.00

RECEIVED
BLM STATE OFFICE
PHOENIX, ARIZONA
SEP 21 2018

Use a separate sheet for additional claim names, serial numbers, and claimant names and addresses.

UNITED STATES
DEPARTMENT OF THE INTERIOR
BUREAU OF LAND MANAGEMENT
**MAINTENANCE FEE PAYMENT FORM
FOR PLACER MINING CLAIMS**

Remitter Name: C. Williams & Marcelline J. Nichols
 Mailing Address: 26134 N. 93rd Ave.
 City, State, Zip: Peoria, AZ 85383

Check here if this is a change of address.

FOR COUNTY RECORDER'S USE

No. of claims 10
 Total due BLM \$ 3100⁰⁰

- The maintenance fee may be paid by cash, check, money order, Bureau of Land Management (BLM) Declining Deposit Account, or credit card (VISA, American Express, Discover, or MasterCard). Payments must be remitted to the BLM State Office where your claim or site is recorded and received on or before September 1. If the payment is mailed, the envelope must be postmarked by a bona fide delivery service on or before September 1 and received at the proper BLM State Office within 15 calendar days after the due date. Payments may also be made by telephone using a credit card. A complete listing of BLM State Offices with their addresses and phone numbers can be found at <http://www.blm.gov>.
- The maintenance fee for the following claim(s) applies to the assessment year 2019.

CLAIM NAME	BLM SERIAL NO.	ACRES IN CLAIM	PAYMENT DUE TO THE BLM (See Instructions on Page 2)
<u>Hila Mountain #36</u>	<u>AMC 394509</u>	<u>40</u>	<u>310⁰⁰</u>
<u>Hila Mountain #37</u>	<u>AMC 394510</u>	<u>40</u>	<u>310⁰⁰</u>
<u>Hila Mountain #38</u>	<u>AMC 394511</u>	<u>40</u>	<u>310⁰⁰</u>
<u>Hila Mountain #39</u>	<u>AMC 394512</u>	<u>40</u>	<u>310⁰⁰</u>
<u>Hila Mountain #40</u>	<u>AMC 394051</u>	<u>40</u>	<u>310⁰⁰</u>
<u>Hila Mountain #41</u>	<u>AMC 394513</u>	<u>40</u>	<u>310⁰⁰</u>
<u>Hila Mountain #42</u>	<u>AMC 396284</u>	<u>40</u>	<u>310⁰⁰</u>
<u>Hila Mountain #43</u>	<u>AMC 396285</u>	<u>40</u>	<u>310⁰⁰</u>
<u>Hila Mountain #44</u>	<u>AMC 397074</u>	<u>40</u>	<u>310⁰⁰</u>
<u>Hila Mountain #45</u>	<u>AMC 397075</u>	<u>40</u>	<u>310⁰⁰</u>

RECEIVED
 BLM AZ STATE OFFICE
 PHOENIX, ARIZONA
 SEP 2 2019

Use a separate sheet for additional claim names, serial numbers, and claimant names and addresses.

UNITED STATES
DEPARTMENT OF THE INTERIOR
BUREAU OF LAND MANAGEMENT
**MAINTENANCE FEE PAYMENT FORM
FOR PLACER MINING CLAIMS**

Remitter Name: C. William +
Marilline J. Nichols
Mailing Address: 26134 N. 93rd Ave
City, State, Zip: Peoria, AZ 85383

Check here if this is a change of address.

FOR COUNTY RECORDER'S USE

No. of claims 5
Total due BLM \$ 1550⁰⁰

- The maintenance fee may be paid by cash, check, money order, Bureau of Land Management (BLM) Declining Deposit Account, or credit card (VISA, American Express, Discover, or MasterCard). Payments must be remitted to the BLM State Office where your claim or site is recorded and received on or before September 1. If the payment is mailed, the envelope must be postmarked by a bona fide delivery service on or before September 1 and received at the proper BLM State Office within 15 calendar days after the due date. Payments may also be made by telephone using a credit card. A complete listing of BLM State Offices with their addresses and phone numbers can be found at <http://www.blm.gov>.
- The maintenance fee for the following claim(s) applies to the assessment year 2019.

CLAIM NAME	BLM SERIAL NO.	ACRES IN CLAIM	PAYMENT DUE TO THE BLM (See Instructions on Page 2)
<u>Hila Mountain #46</u>	<u>AMC 397076</u>	<u>40</u>	<u>310⁰⁰</u>
<u>Hila Mountain #47</u>	<u>AMC 398944</u>	<u>40</u>	<u>310⁰⁰</u>
<u>Hila Mountain #48</u>	<u>AMC 398945</u>	<u>40</u>	<u>310⁰⁰</u>
<u>Hila Mountain #49</u>	<u>AMC 398946</u>	<u>40</u>	<u>310⁰⁰</u>
<u>Hila Mountain #50</u>	<u>AMC 398947</u>	<u>40</u>	<u>310⁰⁰</u>

RECEIVED
BLM AZ STATE OFFICE
2018 SEP -5 P 2:20
PHOENIX, ARIZONA

Use a separate sheet for additional claim names, serial numbers, and claimant names and addresses.

UNITED STATES
DEPARTMENT OF THE INTERIOR
BUREAU OF LAND MANAGEMENT
**MAINTENANCE FEE PAYMENT FORM FOR
LODE CLAIMS, MILL SITES, AND TUNNEL SITES**

Remitter Name: C. William +
Marcelline J. Nichols
Mailing Address: 26134 N. 93rd Ave.
City, State, Zip: Peoria, AZ 85383

Check here if this is a change of address.

FOR COUNTY RECORDER'S USE

No. of claims/sites 10
x \$155 per claim/site
Total due BLM \$ 1550⁰⁰

- The maintenance fee may be paid by cash, check, money order, Bureau of Land Management (BLM) Declining Deposit Account, or credit card (VISA, American Express, Discover, or MasterCard). Payments must be remitted to the BLM State Office where your claim or site is recorded and received on or before September 1. If the payment is mailed, the envelope must be postmarked by a bona fide delivery service on or before September 1 and received at the proper BLM State Office within 15 calendar days after the due date. Payments may also be made by telephone using a credit card. A complete listing of BLM State Offices with their addresses and phone numbers can be found at <http://www.blm.gov>.
- The maintenance fee for the following claim(s)/site(s) applies to the assessment year 2019.

CLAIM/SITE NAME	BLM SERIAL NO.
Peaacho #1	AMC 403665 ⁴⁰³⁶⁶⁵
Peaacho #2	AMC 403666 ⁴⁰³⁶⁶⁶
Hila Mountain #1	AMC 398398 ³⁹⁸³⁹⁸
Sunset #1	AMC 398948 ³⁹⁸⁹⁴⁸
Sunset #2	AMC 398949 ³⁹⁸⁹⁴⁹
Sunset #3	AMC 398950
Sunset #4	AMC 398962
Sunset #5	AMC 398963
Sunset #6	AMC 398964
Sunset #7	AMC 398951

Use a separate sheet for additional claim/site names, serial numbers, and claimant names and addresses.

UNITED STATES
DEPARTMENT OF THE INTERIOR
BUREAU OF LAND MANAGEMENT
**MAINTENANCE FEE PAYMENT FORM FOR
LODE CLAIMS, MILL SITES, AND TUNNEL SITES**

Remitter Name: C. William & Marcelline J. Nichols
 Mailing Address: 26134 N. 93rd Ave.
 City, State, Zip: Peoria, AZ 85383

Check here if this is a change of address.

FOR COUNTY RECORDER'S USE

No. of claims/sites 5
 x \$155 per claim/site
 Total due BLM \$ 775⁰⁰

1. The maintenance fee may be paid by cash, check, money order, Bureau of Land Management (BLM) Declining Deposit Account, or credit card (VISA, American Express, Discover, or MasterCard). Payments must be remitted to the BLM State Office where your claim or site is recorded and received on or before September 1. If the payment is mailed, the envelope must be postmarked by a bona fide delivery service on or before September 1 and received at the proper BLM State Office within 15 calendar days after the due date. Payments may also be made by telephone using a credit card. A complete listing of BLM State Offices with their addresses and phone numbers can be found at <http://www.blm.gov>.

2. The maintenance fee for the following claim(s)/site(s) applies to the assessment year 2019.

CLAIM/SITE NAME	BLM SERIAL NO.
Sunset #8	AMC 398952
Sunset #9	AMC 398953
Sunset #10	AMC 398954
Sunset #11	AMC 398955
Cordes Mountain #1	AMC 439917

RECEIVED
 BLM AZ STATE OFFICE
 PHOENIX, ARIZONA
 2018 SEP - 5 P 2:21

Use a separate sheet for additional claim/site names, serial numbers, and claimant names and addresses.

REGISTERED MAIL



7018 0360 0002 2041 7951

C William & Marcilline Nichols
26134 N 93rd Ave
Peoria AZ 85383-1350



1000



85004

U.S. POSTAGE PAID
FCM LG ENV
GLENDALE, AZ
85308
AUG 31, 18
AMOUNT
\$7.62
R2304N116924-1

RETURN RECEIPT
REQUESTED

RETURN RECEIPT
REQUESTED

Bureau of Land Management
One North Central Ave. Ste 800
Phoenix, AZ 85004-4427

RECEIVED
BLM AZ STATE OFFICE
2018 SEP -5 P 2:20
PHOENIX, ARIZONA

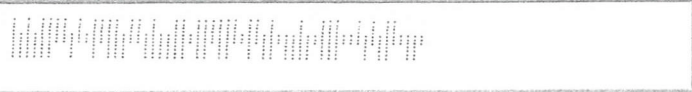

United States Department of the Interior
Bureau of Land Management
 DIV OF LANDS, MINRLS & ENERGY
 ONE N CENTRAL AVE
 PHOENIX, AZ 85004 -4427
 Phone: 602-417-9200

Receipt

No: 4260122

Transaction #: 4375733	
Date of Transaction: 09/11/2018	
CUSTOMER:	
CHARLES WILLIAM NICHOLS 26134 N 93RD AVE PEORIA, AZ 85383-1350 US	

LINE #	QTY	DESCRIPTION	REMARKS	UNIT PRICE	TOTAL
1	1.00	LOCATABLE MINERALS / MINING CLAIMS-NOT NEW-UNADJUD, ONE AUTH NO. ONLY / MINING CLAIM MONEY RECEIVED CASES: AMC445346/\$22165.00	MAINT 2019/143	- n/a -	22165.00
TOTAL:					\$22,165.00

PAYMENT INFORMATION					
1	AMOUNT:	22165.00	POSTMARKED:	N/A	
	TYPE:	CHECK	RECEIVED:	09/05/2018	
	CHECK NO:	221			
	NAME:	NICHOLS, CHARLES WILLIAM 26134 N 93RD AVE PEORIA AZ 85383-1350 US			

REMARKS

This receipt was generated by the automated BLM Collections and Billing System and is a paper representation of a portion of the official electronic record contained therein.

UNITED STATES
DEPARTMENT OF THE INTERIOR
BUREAU OF LAND MANAGEMENT
MAINTENANCE FEE PAYMENT FORM FOR
LODE CLAIMS, MILL SITES, AND TUNNEL SITES

398944
439917
403665

Remitter Name: C. William +
Maralline J Nichols
Mailing Address: 26134 N. 93rd Ave.
City, State, Zip: Peoria, AZ 85383

397074 ~~397074~~ 396392
~~394491~~ 394491 410302
394051 384793
394513 403058
396284

Check here if this is a change of address.

FOR COUNTY RECORDER'S USE

No. of claims/sites 5
x \$155 per claim/site
Total due BLM \$ 775.00

- The maintenance fee may be paid by cash, check, money order, Bureau of Land Management (BLM) Declining Deposit Account, or credit card (VISA, American Express, Discover, or MasterCard). Payments must be remitted to the BLM State Office where your claim or site is recorded and received on or before September 1. If the payment is mailed, the envelope must be postmarked by a bona fide delivery service on or before September 1 and received at the proper BLM State Office within 15 calendar days after the due date. Payments may also be made by telephone using a credit card. A complete listing of BLM State Offices with their addresses and phone numbers can be found at <http://www.blm.gov>.
- The maintenance fee for the following claim(s)/site(s) applies to the assessment year 2018.

CLAIM/SITE NAME	BLM SERIAL NO.
Sunset #8	AMC 398952
Sunset #9	AMC 398953
Sunset #10	AMC 398954
Sunset #11	AMC 398955
Cordes Mountain #1	AMC 439917

RECEIVED
OFFICE
2011 AUG 31 AM 10:47
PHOENIX, ARIZONA

Use a separate sheet for additional claim/site names, serial numbers, and claimant names and addresses.

(Continued on page 2)

INTERIOR
SEP 01 2017
BY: R Am

UNITED STATES
DEPARTMENT OF THE INTERIOR
BUREAU OF LAND MANAGEMENT
**MAINTENANCE FEE PAYMENT FORM FOR
LODE CLAIMS, MILL SITES, AND TUNNEL SITES**

Remitter Name: C. William +
Marcelline J. Nichols
Mailing Address: 26134 N. 93rd Ave.
City, State, Zip: Peoria, AZ 85383

Check here if this is a change of address.

FOR COUNTY RECORDER'S USE

No. of claims/sites 10
x \$155 per claim/site
Total due BLM \$ 1550.00

- The maintenance fee may be paid by cash, check, money order, Bureau of Land Management (BLM) Declining Deposit Account, or credit card (VISA, American Express, Discover, or MasterCard). Payments must be remitted to the BLM State Office where your claim or site is recorded and received on or before September 1. If the payment is mailed, the envelope must be postmarked by a bona fide delivery service on or before September 1 and received at the proper BLM State Office within 15 calendar days after the due date. Payments may also be made by telephone using a credit card. A complete listing of BLM State Offices with their addresses and phone numbers can be found at <http://www.blm.gov>.
- The maintenance fee for the following claim(s)/site(s) applies to the assessment year 2018.

CLAIM/SITE NAME	BLM SERIAL NO.
Peacho #1	AMC 403665
Peacho #2	AMC 403666
Hila Mountain #1	AMC 396392
Sunset #1	AMC 398948
Sunset #2	AMC 398949
Sunset #3	AMC 398950
Sunset #4	AMC 398962
Sunset #5	AMC 398963
Sunset #6	AMC 398964
Sunset #7	AMC 398951

Use a separate sheet for additional claim/site names, serial numbers, and claimant names and addresses.

RECEIVED
BLM AZ STATE OFFICE
2017 AUG 31 10:47

UNITED STATES
DEPARTMENT OF THE INTERIOR
BUREAU OF LAND MANAGEMENT
**MAINTENANCE FEE PAYMENT FORM
FOR PLACER MINING CLAIMS**

Remitter Name: C. William +
Marcelline J Nichols
Mailing Address: 26134 N. 93rd Ave.
City, State, Zip: Peoria, AZ 85383

Check here if this is a change of address.

FOR COUNTY RECORDER'S USE

No. of claims 10
Total due BLM \$ 3,100.00

- The maintenance fee may be paid by cash, check, money order, Bureau of Land Management (BLM) Declining Deposit Account, or credit card (VISA, American Express, Discover, or MasterCard). Payments must be remitted to the BLM State Office where your claim or site is recorded and received on or before September 1. If the payment is mailed, the envelope must be postmarked by a bona fide delivery service on or before September 1 and received at the proper BLM State Office within 15 calendar days after the due date. Payments may also be made by telephone using a credit card. A complete listing of BLM State Offices with their addresses and phone numbers can be found at <http://www.blm.gov>.
- The maintenance fee for the following claim(s) applies to the assessment year 2018

CLAIM NAME	BLM SERIAL NO.	ACRES IN CLAIM	PAYMENT DUE TO THE BLM (See Instructions on Page 2)
<u>Cordes Peak #1</u>	<u>AMC 410303</u>	<u>40</u>	<u>310.00</u>
<u>Cordes Peak #2</u>	<u>AMC 410304</u>	<u>40</u>	<u>310.00</u>
<u>Estrella #1</u>	<u>AMC 384793</u>	<u>40</u>	<u>310.00</u>
<u>Estrella #2</u>	<u>AMC 384794</u>	<u>40</u>	<u>310.00</u>
<u>Estrella #3</u>	<u>AMC 384795</u>	<u>40</u>	<u>310.00</u>
<u>Estrella #4</u>	<u>AMC 384796</u>	<u>40</u>	<u>310.00</u>
<u>Hila Mountain #1</u>	<u>AMC 403058</u>	<u>40</u>	<u>310.00</u>
<u>Hila Mountain #2</u>	<u>AMC 403059</u>	<u>40</u>	<u>310.00</u>
<u>Hila Mountain #3</u>	<u>AMC 403060</u>	<u>40</u>	<u>310.00</u>
<u>Hila Mountain #4</u>	<u>AMC 403061</u>	<u>40</u>	<u>310.00</u>

Use a separate sheet for additional claim names, serial numbers, and claimant names and addresses.

RECEIVED
BLM STATE OFFICE
2017 AUG 31 10:47

UNITED STATES
DEPARTMENT OF THE INTERIOR
BUREAU OF LAND MANAGEMENT
**MAINTENANCE FEE PAYMENT FORM
FOR PLACER MINING CLAIMS**

Remitter Name: C. William +
Marilline J. Nichols
Mailing Address: 26134 N. 93rd Ave.
City, State, Zip: Peoria, AZ 85383

Check here if this is a change of address.

FOR COUNTY RECORDER'S USE

No. of claims 10
Total due BLM \$ 3100.00

- The maintenance fee may be paid by cash, check, money order, Bureau of Land Management (BLM) Declining Deposit Account, or credit card (VISA, American Express, Discover, or MasterCard). Payments must be remitted to the BLM State Office where your claim or site is recorded and received on or before September 1. If the payment is mailed, the envelope must be postmarked by a bona fide delivery service on or before September 1 and received at the proper BLM State Office within 15 calendar days after the due date. Payments may also be made by telephone using a credit card. A complete listing of BLM State Offices with their addresses and phone numbers can be found at <http://www.blm.gov>.
- The maintenance fee for the following claim(s) applies to the assessment year 2018.

CLAIM NAME	BLM SERIAL NO.	ACRES IN CLAIM	PAYMENT DUE TO THE BLM (See Instructions on Page 2)
Sila Mountain #6	AMC 384797	40	310.00
Sila Mountain #7	AMC 384798	40	310.00
Sila Mountain #8	AMC 384799	40	310.00
Sila Mountain #9	AMC 384800	40	310.00
Sila Mountain #10	AMC 384801	40	310.00
Sila Mountain #11	AMC 384802	40	310.00
Sila Mountain #12	AMC 384803	40	310.00
Sila Mountain #13	AMC 384804	40	310.00
Sila Mountain #14	AMC 384805	40	310.00
Sila Mountain #15	AMC 384806	40	310.00

Use a separate sheet for additional claim names, serial numbers, and claimant names and addresses.

RECEIVED
BLM STATE OFFICE
PHOENIX, ARIZONA
AUG 31 10:41 AM '18

UNITED STATES
DEPARTMENT OF THE INTERIOR
BUREAU OF LAND MANAGEMENT
**MAINTENANCE FEE PAYMENT FORM
FOR PLACER MINING CLAIMS**

Remitter Name: C William +
Marilline J Nichols

Mailing Address: 26134 N. 93rd Ave.

City, State, Zip: Peoria, AZ 85383

Check here if this is a change of address.

FOR COUNTY RECORDER'S USE

No. of claims 10
Total due BLM \$ 3100.00

- The maintenance fee may be paid by cash, check, money order, Bureau of Land Management (BLM) Declining Deposit Account, or credit card (VISA, American Express, Discover, or MasterCard). Payments must be remitted to the BLM State Office where your claim or site is recorded and received on or before September 1. If the payment is mailed, the envelope must be postmarked by a bona fide delivery service on or before September 1 and received at the proper BLM State Office within 15 calendar days after the due date. Payments may also be made by telephone using a credit card. A complete listing of BLM State Offices with their addresses and phone numbers can be found at <http://www.blm.gov>.
- The maintenance fee for the following claim(s) applies to the assessment year 2018.

CLAIM NAME	BLM SERIAL NO.	ACRES IN CLAIM	PAYMENT DUE TO THE BLM (See Instructions on Page 2)
Dila Mountain #16	AMC 384807	40	310.00
Dila Mountain #17	AMC 384808	40	310.00
Dila Mountain #18	AMC 394491	40	310.00
Dila Mountain #19	AMC 394492	40	310.00
Dila Mountain #20	AMC 394493	40	310.00
Dila Mountain #21	AMC 394494	40	310.00
Dila Mountain #22	AMC 394495	40	310.00
Dila Mountain #23	AMC 394496	40	310.00
Dila Mountain #24	AMC 394497	40	310.00
Dila Mountain #25	AMC 394498	40	310.00

RECEIVED
BLM STATE OFFICE
2017 AUG 31 10:17

Use a separate sheet for additional claim names, serial numbers, and claimant names and addresses.

UNITED STATES
DEPARTMENT OF THE INTERIOR
BUREAU OF LAND MANAGEMENT
**MAINTENANCE FEE PAYMENT FORM
FOR PLACER MINING CLAIMS**

Remitter Name: C William & Masulline J Nichols

Mailing Address: 26134 N. 93rd Ave.

City, State, Zip: Peoria, AZ 85383

Check here if this is a change of address.

FOR COUNTY RECORDER'S USE

No. of claims 10
Total due BLM \$ 3100.00

- The maintenance fee may be paid by cash, check, money order, Bureau of Land Management (BLM) Declining Deposit Account, or credit card (VISA, American Express, Discover, or MasterCard). Payments must be remitted to the BLM State Office where your claim or site is recorded and received on or before September 1. If the payment is mailed, the envelope must be postmarked by a bona fide delivery service on or before September 1 and received at the proper BLM State Office within 15 calendar days after the due date. Payments may also be made by telephone using a credit card. A complete listing of BLM State Offices with their addresses and phone numbers can be found at <http://www.blm.gov>.
- The maintenance fee for the following claim(s) applies to the assessment year 2018.

CLAIM NAME	BLM SERIAL NO.	ACRES IN CLAIM	PAYMENT DUE TO THE BLM (See Instructions on Page 2)
Sila Mountain #26	AMC 394499	40	310.00
Sila Mountain #27	AMC 394500	40	310.00
Sila Mountain #28	AMC 394501	40	310.00
Sila Mountain #29	AMC 394502	40	310.00
Sila Mountain #30	AMC 394503	40	310.00
Sila Mountain #31	AMC 394504	40	310.00
Sila Mountain #32	AMC 394505	40	310.00
Sila Mountain #33	AMC 394506	40	310.00
Sila Mountain #34	AMC 394507	40	310.00
Sila Mountain #35	AMC 394508	40	310.00

Use a separate sheet for additional claim names, serial numbers, and claimant names and addresses.

RECEIVED
BLM STATE OFFICE

UNITED STATES
DEPARTMENT OF THE INTERIOR
BUREAU OF LAND MANAGEMENT
**MAINTENANCE FEE PAYMENT FORM
FOR PLACER MINING CLAIMS**

Remitter Name: C. William & Marcelline J. Nichols
 Mailing Address: 26134 N. 93rd Ave.
 City, State, Zip: Peoria, AZ 85383
 Check here if this is a change of address.

FOR COUNTY RECORDER'S USE

No. of claims 10
 Total due BLM \$ 3100.00

- The maintenance fee may be paid by cash, check, money order, Bureau of Land Management (BLM) Declining Deposit Account, or credit card (VISA, American Express, Discover, or MasterCard). Payments must be remitted to the BLM State Office where your claim or site is recorded and received on or before September 1. If the payment is mailed, the envelope must be postmarked by a bona fide delivery service on or before September 1 and received at the proper BLM State Office within 15 calendar days after the due date. Payments may also be made by telephone using a credit card. A complete listing of BLM State Offices with their addresses and phone numbers can be found at <http://www.blm.gov>.
- The maintenance fee for the following claim(s) applies to the assessment year 2018

CLAIM NAME	BLM SERIAL NO.	ACRES IN CLAIM	PAYMENT DUE TO THE BLM (See Instructions on Page 2)
Sila Mountain #36	AMC 394509	40	310.00
Sila Mountain #37	AMC 394510	40	310.00
Sila Mountain #38	AMC 394511	40	310.00
Sila Mountain #39	AMC 394512	40	310.00
Sila Mountain #40	AMC 394051	40	310.00
Sila Mountain #41	AMC 934513	40	310.00
Sila Mountain #42	AMC 396284	40	310.00
Sila Mountain #43	AMC 396285	40	310.00
Sila Mountain #44	AMC 397074	40	310.00
Sila Mountain #45	AMC 397075	40	310.00

2017 AUG 31 10:47

Use a separate sheet for additional claim names, serial numbers, and claimant names and addresses.

RECEIVED
BLM AZ STATE OFFICE
PHOENIX, ARIZONA

UNITED STATES
DEPARTMENT OF THE INTERIOR
BUREAU OF LAND MANAGEMENT
**MAINTENANCE FEE PAYMENT FORM
FOR PLACER MINING CLAIMS**

Remitter Name: C. William +
Marilyn J. Nichols
Mailing Address: 26134 N. 93rd Ave
City, State, Zip: Peoria, AZ 85383

Check here if this is a change of address.

FOR COUNTY RECORDER'S USE

No. of claims 5
Total due BLM \$ 1550.00

- The maintenance fee may be paid by cash, check, money order, Bureau of Land Management (BLM) Declining Deposit Account, or credit card (VISA, American Express, Discover, or MasterCard). Payments must be remitted to the BLM State Office where your claim or site is recorded and received on or before September 1. If the payment is mailed, the envelope must be postmarked by a bona fide delivery service on or before September 1 and received at the proper BLM State Office within 15 calendar days after the due date. Payments may also be made by telephone using a credit card. A complete listing of BLM State Offices with their addresses and phone numbers can be found at <http://www.blm.gov>.
- The maintenance fee for the following claim(s) applies to the assessment year 2018.

CLAIM NAME	BLM SERIAL NO.	ACRES IN CLAIM	PAYMENT DUE TO THE BLM (See Instructions on Page 2)
<u>Sila Mountain #46</u>	<u>AMC 397076</u>	<u>40</u>	<u>310.00</u>
<u>Sila Mountain #47</u>	<u>AMC 398944</u>	<u>40</u>	<u>310.00</u>
<u>Sila Mountain #48</u>	<u>AMC 398945</u>	<u>40</u>	<u>310.00</u>
<u>Sila Mountain #49</u>	<u>AMC 398946</u>	<u>40</u>	<u>310.00</u>
<u>Sila Mountain #50</u>	<u>AMC 398947</u>	<u>40</u>	<u>310.00</u>

RECEIVED
STATE OFFICE
2017 AUG 31 AM 10:45
PHOENIX, ARIZONA

Use a separate sheet for additional claim names, serial numbers, and claimant names and addresses.

United States Department of the Interior
Bureau of Land Management
 DIV OF LANDS, MINRLS & ENERGY
 ONE N CENTRAL AVE
 PHOENIX, AZ 85004 -4427
 Phone: 602-417-9200

Receipt

No: 3967285

Transaction #: 4077176	
Date of Transaction: 08/31/2017	
CUSTOMER:	
C W ILLIAM NICHOLS 26134 N 93AVE PEORIA,AZ 85383 US	

LINE #	QTY	DESCRIPTION	REMARKS	UNIT PRICE	TOTAL
1	1.00	LOCATABLE MINERALS / MINING CLAIMS- NOT NEW-UNADJUD,ONE AUTH NO. ONLY / MINING CLAIM MONEY RECEIVED CASES: AMC398952/\$19375.00	2018 MAINT/70	- n/a -	19375.00
TOTAL:					\$19,375.00

PAYMENT INFORMATION			
1	AMOUNT:	19375.00	POSTMARKED: N/A
	TYPE:	CHECK	RECEIVED: 08/31/2017
	CHECK NO:	207	
	NAME:	NICHOLS, C W ILLIAM 26134 N 93AVE PEORIA AZ 85383 US	

REMARKS

This receipt was generated by the automated BLM Collections and Billing System and is a paper representation of a portion of the official electronic record contained therein.

UNITED STATES
DEPARTMENT OF THE INTERIOR
BUREAU OF LAND MANAGEMENT
**MAINTENANCE FEE PAYMENT FORM
FOR PLACER MINING CLAIMS**

Remitter Name: C. William + Mariline J. Nichols
 Mailing Address: 26134 N. 93rd Ave.
 City, State, Zip: Peoria, AZ 85383

Check here if this is a change of address.

AMC 384793	AMC 397074
394051	398944
394491	398962
394513	403058
396284	403665
396392	410302

FOR COUNTY RECORDER'S USE

No. of claims 10
 Total due BLM \$ 3100.00

- The maintenance fee may be paid by cash, check, money order, Bureau of Land Management (BLM) Declining Deposit Account, or credit card (VISA, American Express, Discover, or MasterCard). Payments must be remitted to the BLM State Office where your claim or site is recorded and received on or before September 1. If the payment is mailed, the envelope must be postmarked by a bona fide delivery service on or before September 1 and received at the proper BLM State Office within 15 calendar days after the due date. Payments may also be made by telephone using a credit card. A complete listing of BLM State Offices with their addresses and phone numbers can be found at <http://www.blm.gov>.
- The maintenance fee for the following claim(s) applies to the assessment year 2017.

CLAIM NAME	BLM SERIAL NO.	ACRES IN CLAIM	PAYMENT DUE TO THE BLM (See Instructions on Page 2)
Sila Mountain #6	AMC 384797	40	310.00
Sila Mountain #7	AMC 384798	40	310.00
Sila Mountain #8	AMC 384799	40	310.00
Sila Mountain #9	AMC 384800	40	310.00
Sila Mountain #10	AMC 384801	40	310.00
Sila Mountain #11	AMC 384802	40	310.00
Sila Mountain #12	AMC 384803	40	310.00
Sila Mountain #13	AMC 384804	40	310.00
Sila Mountain #14	AMC 384805	40	310.00
Sila Mountain #15	AMC 384806	40	310.00

Use a separate sheet for additional claim names, serial numbers, and claimant names and addresses.

ENTERED INTO COMPUTER
9/11/16 To

RECEIVED
BLM AZ STATE OFFICE
816 V 1 AUG 31 9 18

UNITED STATES
DEPARTMENT OF THE INTERIOR
BUREAU OF LAND MANAGEMENT
**MAINTENANCE FEE PAYMENT FORM
FOR PLACER MINING CLAIMS**

Remitter Name: C. William +
Marcelline J Nichols
Mailing Address: 26134 N. 93rd Ave.
City, State, Zip: Peoria, AZ 85383

Check here if this is a change of address.

FOR COUNTY RECORDER'S USE

No. of claims 10
Total due BLM \$ 3100.00

- The maintenance fee may be paid by cash, check, money order, Bureau of Land Management (BLM) Declining Deposit Account, or credit card (VISA, American Express, Discover, or MasterCard). Payments must be remitted to the BLM State Office where your claim or site is recorded and received on or before September 1. If the payment is mailed, the envelope must be postmarked by a bona fide delivery service on or before September 1 and received at the proper BLM State Office within 15 calendar days after the due date. Payments may also be made by telephone using a credit card. A complete listing of BLM State Offices with their addresses and phone numbers can be found at <http://www.blm.gov>.
- The maintenance fee for the following claim(s) applies to the assessment year 2017.

CLAIM NAME	BLM SERIAL NO.	ACRES IN CLAIM	PAYMENT DUE TO THE BLM (See Instructions on Page 2)
Sila Mountain #16	AMC 384807	40	310.00
Sila Mountain #17	AMC 384808	40	310.00
Sila Mountain #18	AMC 394491	40	310.00
Sila Mountain #19	AMC 394492	40	310.00
Sila Mountain #20	AMC 394493	40	310.00
Sila Mountain #21	AMC 394494	40	310.00
Sila Mountain #22	AMC 394495	40	310.00
Sila Mountain #23	AMC 394496	40	310.00
Sila Mountain #24	AMC 394497	40	310.00
Sila Mountain #25	AMC 394498	40	310.00

Use a separate sheet for additional claim names, serial numbers, and claimant names and addresses.

RECEIVED
BLM AZ STATE OFFICE
2018 AUG 31 9 18 AM
PHOENIX, ARIZONA

UNITED STATES
DEPARTMENT OF THE INTERIOR
BUREAU OF LAND MANAGEMENT
**MAINTENANCE FEE PAYMENT FORM
FOR PLACER MINING CLAIMS**

Remitter Name: D. William & Marcelline J. Nichols

Mailing Address: 26134 N. 93rd Ave.

City, State, Zip: Peoria, AZ 85383

Check here if this is a change of address.

FOR COUNTY RECORDER'S USE

No. of claims 10
Total due BLM \$ 3100.00

- The maintenance fee may be paid by cash, check, money order, Bureau of Land Management (BLM) Declining Deposit Account, or credit card (VISA, American Express, Discover, or MasterCard). Payments must be remitted to the BLM State Office where your claim or site is recorded and received on or before September 1. If the payment is mailed, the envelope must be postmarked by a bona fide delivery service on or before September 1 and received at the proper BLM State Office within 15 calendar days after the due date. Payments may also be made by telephone using a credit card. A complete listing of BLM State Offices with their addresses and phone numbers can be found at <http://www.blm.gov>.
- The maintenance fee for the following claim(s) applies to the assessment year 2017.

CLAIM NAME	BLM SERIAL NO.	ACRES IN CLAIM	PAYMENT DUE TO THE BLM (See Instructions on Page 2)
<u>Sila Mountain #26</u>	<u>AMC 394499</u>	<u>40</u>	<u>310.00</u>
<u>Sila Mountain #27</u>	<u>AMC 394500</u>	<u>40</u>	<u>310.00</u>
<u>Sila Mountain #28</u>	<u>AMC 394501</u>	<u>40</u>	<u>310.00</u>
<u>Sila Mountain #29</u>	<u>AMC 394502</u>	<u>40</u>	<u>310.00</u>
<u>Sila Mountain #30</u>	<u>AMC 394503</u>	<u>40</u>	<u>310.00</u>
<u>Sila Mountain #31</u>	<u>AMC 394504</u>	<u>40</u>	<u>310.00</u>
<u>Sila Mountain #32</u>	<u>AMC 394505</u>	<u>40</u>	<u>310.00</u>
<u>Sila Mountain #33</u>	<u>AMC 394506</u>	<u>40</u>	<u>310.00</u>
<u>Sila Mountain #34</u>	<u>AMC 394507</u>	<u>40</u>	<u>310.00</u>
<u>Sila Mountain #35</u>	<u>AMC 394508</u>	<u>40</u>	<u>310.00</u>

Use a separate sheet for additional claim names, serial numbers, and claimant names and addresses.

RECEIVED
BLM AZ STATE OFFICE
PHOENIX, ARIZONA
AUG 31 9 18 AM '17

UNITED STATES
DEPARTMENT OF THE INTERIOR
BUREAU OF LAND MANAGEMENT
**MAINTENANCE FEE PAYMENT FORM
FOR PLACER MINING CLAIMS**

Remitter Name: C. William & Marcelline J. Nichols

Mailing Address: 26134 N. 93rd Ave.

City, State, Zip: Peoria, AZ 85383

Check here if this is a change of address.

FOR COUNTY RECORDER'S USE

No. of claims 10
Total due BLM \$ 3100.00

- The maintenance fee may be paid by cash, check, money order, Bureau of Land Management (BLM) Declining Deposit Account, or credit card (VISA, American Express, Discover, or MasterCard). Payments must be remitted to the BLM State Office where your claim or site is recorded and received on or before September 1. If the payment is mailed, the envelope must be postmarked by a bona fide delivery service on or before September 1 and received at the proper BLM State Office within 15 calendar days after the due date. Payments may also be made by telephone using a credit card. A complete listing of BLM State Offices with their addresses and phone numbers can be found at <http://www.blm.gov>.
- The maintenance fee for the following claim(s) applies to the assessment year 2017.

CLAIM NAME	BLM SERIAL NO.	ACRES IN CLAIM	PAYMENT DUE TO THE BLM (See Instructions on Page 2)
Sila Mountain #36	AMC 394509	40	310.00
Sila Mountain #37	AMC 394509	10 40	310.00
Sila Mountain #38	AMC 394511	40	310.00
Sila Mountain #39	AMC 394512	40	310.00
Sila Mountain #40	AMC 394051	40	310.00
Sila Mountain #41	AMC 934513	40	310.00
Sila Mountain #42	AMC 296284	40	310.00
Sila Mountain #43	AMC 396285	40	310.00
Sila Mountain #44	AMC 397074	40	310.00
Sila Mountain #45	AMC 397075	40	310.00

- 394510
394513

Use a separate sheet for additional claim names, serial numbers, and claimant names and addresses.

RECEIVED
BLM AZ STATE OFFICE
PHOENIX, ARIZONA
AUG 31 9 19 2017

UNITED STATES
DEPARTMENT OF THE INTERIOR
BUREAU OF LAND MANAGEMENT
**MAINTENANCE FEE PAYMENT FORM
FOR PLACER MINING CLAIMS**

Remitter Name: C. William +
Marcelline J. Nichols
Mailing Address: 26134 N. 93rd Ave
City, State, Zip: Peoria, AZ 85383

Check here if this is a change of address.

FOR COUNTY RECORDER'S USE

No. of claims 5
Total due BLM \$ 1550.00

- The maintenance fee may be paid by cash, check, money order, Bureau of Land Management (BLM) Declining Deposit Account, or credit card (VISA, American Express, Discover, or MasterCard). Payments must be remitted to the BLM State Office where your claim or site is recorded and received on or before September 1. If the payment is mailed, the envelope must be postmarked by a bona fide delivery service on or before September 1 and received at the proper BLM State Office within 15 calendar days after the due date. Payments may also be made by telephone using a credit card. A complete listing of BLM State Offices with their addresses and phone numbers can be found at <http://www.blm.gov>.
- The maintenance fee for the following claim(s) applies to the assessment year 2017.

CLAIM NAME	BLM SERIAL NO.	ACRES IN CLAIM	PAYMENT DUE TO THE BLM (See Instructions on Page 2)
<u>Sila Mountain #46</u>	<u>AMC 397076</u>	<u>40</u>	<u>310.00</u>
<u>Sila Mountain #47</u>	<u>AMC 398944</u>	<u>40</u>	<u>310.00</u>
<u>Sila Mountain #48</u>	<u>AMC 398945</u>	<u>40</u>	<u>310.00</u>
<u>Sila Mountain #49</u>	<u>AMC 398946</u>	<u>40</u>	<u>310.00</u>
<u>Sila Mountain #50</u>	<u>AMC 398947</u>	<u>40</u>	<u>310.00</u>

RECEIVED
 BLM AZ STATE OFFICE
 2018 AUG 31 A 9:19
 PHOENIX, ARIZONA

Use a separate sheet for additional claim names, serial numbers, and claimant names and addresses.

UNITED STATES
DEPARTMENT OF THE INTERIOR
BUREAU OF LAND MANAGEMENT
**MAINTENANCE FEE PAYMENT FORM
FOR PLACER MINING CLAIMS**

Remitter Name: C. William +
Marcelline J Nichols

Mailing Address: 26134 N. 93rd Ave.

City, State, Zip: Peoria, AZ 85383

Check here if this is a change of address.

FOR COUNTY RECORDER'S USE

No. of claims 10
Total due BLM \$ 3100.00

- The maintenance fee may be paid by cash, check, money order, Bureau of Land Management (BLM) Declining Deposit Account, or credit card (VISA, American Express, Discover, or MasterCard). Payments must be remitted to the BLM State Office where your claim or site is recorded and received on or before September 1. If the payment is mailed, the envelope must be postmarked by a bona fide delivery service on or before September 1 and received at the proper BLM State Office within 15 calendar days after the due date. Payments may also be made by telephone using a credit card. A complete listing of BLM State Offices with their addresses and phone numbers can be found at <http://www.blm.gov>.
- The maintenance fee for the following claim(s) applies to the assessment year 2017.

CLAIM NAME	BLM SERIAL NO.	ACRES IN CLAIM	PAYMENT DUE TO THE BLM (See Instructions on Page 2)
<u>Cordes Peak #1</u>	<u>AMC 410303</u>	<u>40</u>	<u>310.00</u>
<u>Cordes Peak #2</u>	<u>AMC 410304</u>	<u>40</u>	<u>310.00</u>
<u>Estrella #1</u>	<u>AMC 384793</u>	<u>40</u>	<u>310.00</u>
<u>Estrella #2</u>	<u>AMC 384794</u>	<u>40</u>	<u>310.00</u>
<u>Estrella #3</u>	<u>AMC 384795</u>	<u>40</u>	<u>310.00</u>
<u>Estrella #4</u>	<u>AMC 384796</u>	<u>40</u>	<u>310.00</u>
<u>Sila Mountain #1</u>	<u>AMC 403058</u>	<u>40</u>	<u>310.00</u>
<u>Sila Mountain #2</u>	<u>AMC 403059</u>	<u>40</u>	<u>310.00</u>
<u>Sila Mountain #3</u>	<u>AMC 403060</u>	<u>40</u>	<u>310.00</u>
<u>Sila Mountain #4</u>	<u>AMC 403061</u>	<u>40</u>	<u>310.00</u>

Use a separate sheet for additional claim names, serial numbers, and claimant names and addresses.

RECEIVED
BLM AZ STATE OFFICE
2018 AUG 31 10 49 AM
PHOENIX, ARIZONA

UNITED STATES
DEPARTMENT OF THE INTERIOR
BUREAU OF LAND MANAGEMENT
**MAINTENANCE FEE PAYMENT FORM FOR
LODE CLAIMS, MILL SITES, AND TUNNEL SITES**

Remitter Name: C. William +
Marcelline J. Nichols
Mailing Address: 26134 N. 93rd Ave.
City, State, Zip: Peoria, AZ 85383

Check here if this is a change of address.

FOR COUNTY RECORDER'S USE

No. of claims/sites 10
x \$155 per claim/site
Total due BLM \$ 1550⁰⁰

- The maintenance fee may be paid by cash, check, money order, Bureau of Land Management (BLM) Declining Deposit Account, or credit card (VISA, American Express, Discover, or MasterCard). Payments must be remitted to the BLM State Office where your claim or site is recorded and received on or before September 1. If the payment is mailed, the envelope must be postmarked by a bona fide delivery service on or before September 1 and received at the proper BLM State Office within 15 calendar days after the due date. Payments may also be made by telephone using a credit card. A complete listing of BLM State Offices with their addresses and phone numbers can be found at <http://www.blm.gov>.
- The maintenance fee for the following claim(s)/site(s) applies to the assessment year 2017.

CLAIM/SITE NAME	BLM SERIAL NO.
Picacho #1	AMC 403665
Picacho #2	AMC 403666
Hila Mountain #1	AMC 396392
Sunset #1	AMC 398948
Sunset #2	AMC 398949
Sunset #3	AMC 398950
Sunset #4	AMC 398962
Sunset #5	AMC 398963
Sunset #6	AMC 398964
Sunset #7	AMC 398951

816 V 1E 9U 31 A 9 18

Use a separate sheet for additional claim/site names, serial numbers, and claimant names and addresses.

RECEIVED
BLM AZ STATE OFFICE

UNITED STATES
DEPARTMENT OF THE INTERIOR
BUREAU OF LAND MANAGEMENT
MAINTENANCE FEE PAYMENT FORM FOR
LODE CLAIMS, MILL SITES, AND TUNNEL SITES

Remitter Name: C. William +
Marcelline J Nichols
Mailing Address: 26134 N. 93rd Ave.
City, State, Zip: Pecunia, AZ 85383

384793 397074
394051 398944
394491 398962
394513 403058
396284 403665
396392 410302

Check here if this is a change of address.

FOR COUNTY RECORDER'S USE

No. of claims/sites 5
x \$155 per claim/site
Total due BLM \$ 775⁰⁰

- 1. The maintenance fee may be paid by cash, check, money order, Bureau of Land Management (BLM) Declining Deposit Account, or credit card (VISA, American Express, Discover, or MasterCard). Payments must be remitted to the BLM State Office where your claim or site is recorded and received on or before September 1. If the payment is mailed, the envelope must be postmarked by a bona fide delivery service on or before September 1 and received at the proper BLM State Office within 15 calendar days after the due date. Payments may also be made by telephone using a credit card. A complete listing of BLM State Offices with their addresses and phone numbers can be found at <http://www.blm.gov>.
- 2. The maintenance fee for the following claim(s)/site(s) applies to the assessment year 2017.

CLAIM/SITE NAME	BLM SERIAL NO.
<u>Sunset #8</u>	<u>AMC 398952</u>
<u>Sunset #9</u>	<u>AMC 398953</u>
<u>Sunset #10</u>	<u>AMC 398954</u>
<u>Sunset #11</u>	<u>AMC 398955</u>
<u>Cordes Mountain #1</u>	<u>AMC 410302</u>

RECEIVED
BLM AZ STATE OFFICE
2016 AUG 31 A 9:18
PHOENIX, ARIZONA

INSUFFICIENT
FUNDS
short by \$18.00
RB

Use a separate sheet for additional claim/site names, serial numbers, and claimant names and addresses.

PER Recd. 3647614

United States Department of the Interior
Bureau of Land Management
 DIV OF LANDS, MINRLS & ENERGY
 ONE N CENTRAL AVE
 PHOENIX, AZ 85004 -4427
 Phone: 602-417-9200

Receipt

No: 3647614

Transaction #: 3751602		ENTERED INTO COMPUTER
Date of Transaction: 08/31/2016		
CUSTOMER: 9/1/16 20		
CWILLIAMS NICHOLS 26134 N 93RD AVE PEORIA, AZ 85383-1350 US		

LINE #	QTY	DESCRIPTION	REMARKS	UNIT PRICE	TOTAL
1	1.00	LOCATABLE MINERALS / MINING CLAIMS- NOT NEW-UNADJUD, ONE AUTH NO. ONLY / MINING CLAIM MONEY RECEIVED CASES: AMC398952/\$19357.00	2017 MAINT/70	- n/a -	19357.00
TOTAL:					\$19,357.00

PAYMENT INFORMATION			
1	AMOUNT:	19357.00	POSTMARKED: N/A
	TYPE:	CHECK	RECEIVED: 08/31/2016
	CHECK NO:	191	
	NAME:	NICHOLS, CWILLIAMS 26134 N 93RD AVE PEORIA AZ 85383-1350 US	

REMARKS
<i>\$19375 should have been submitted. Short \$1800 for AMC 410302. Refund 13100 after closure is sent</i>

This receipt was generated by the automated BLM Collections and Billing System and is a paper representation of a portion of the official electronic record contained therein.

ENTERED
 SEP - 1 2016
 BY:

DEPARTMENT OF THE INTERIOR
BUREAU OF LAND MANAGEMENT
MAINTENANCE FEE PAYMENT FORM
FOR PLACER MINING CLAIMS

394491
394051
394513

Remitter Name: C. William & Marcelline J. Nichols
Mailing Address: 26134 N. 93rd Ave.
City, State, Zip: Peoria, AZ 85383

396284
397074

Check here if this is a change of address.

FOR COUNTY RECORDER'S USE

No. of claims 10
Total due BLM \$ 3100.00

- The maintenance fee may be paid by cash, check, money order, Bureau of Land Management (BLM) Declining Deposit Account, or credit card (VISA, American Express, Discover, or MasterCard). Payments must be remitted to the BLM State Office where your claim or site is recorded and received on or before September 1. If the payment is mailed, the envelope must be postmarked by a bona fide delivery service on or before September 1 and received at the proper BLM State Office within 15 calendar days after the due date. Payments may also be made by telephone using a credit card. A complete listing of BLM State Offices with their addresses and phone numbers can be found at <http://www.blm.gov>.
- The maintenance fee for the following claim(s) applies to the assessment year 2016.

CLAIM NAME	BLM SERIAL NO.	ACRES IN CLAIM	PAYMENT DUE TO THE BLM (See Instructions on Page 2)
Sila Mountain #36	AMC 394509	40	310.00
Sila Mountain #37	AMC 394509	40	310.00
Sila Mountain #38	AMC 394511	40	310.00
Sila Mountain #39	AMC 394512	40	310.00
Sila Mountain #40	AMC 394051	40	310.00
Sila Mountain #41	AMC 394513	40	310.00
Sila Mountain #42	AMC 396284	40	310.00
Sila Mountain #43	AMC 396285	40	310.00
Sila Mountain #44	AMC 397074	40	310.00
Sila Mountain #45	AMC 397075	40	310.00

Use a separate sheet for additional claim names, serial numbers, and claimant names and addresses.

(Continued on page 2)

3379625

RECEIVED
STATE OFFICE
ARIZONA
MAY 11 11:00 AM '16

Ram

United States Department of the Interior
Bureau of Land Management
 LANDS/RECREATION & PLANNING
 ONE N CENTRAL AVE
 PHOENIX, AZ 85004 -2203
 Phone: 602-417-9200

Receipt

No:

3379625

Transaction #: 3477886	
Date of Transaction: 08/28/2015	
CUSTOMER:	
CHARLES WILLIAM NICHOLS 26134 N 93RD AVE PEORIA, AZ 85383-1350 US	

LINE #	QTY	DESCRIPTION	REMARKS	UNIT PRICE	TOTAL
1	1.00	LOCATABLE MINERALS / MINING CLAIMS-NOT NEW-UNADJUD, ONE AUTH NO. ONLY / MINING CLAIM MONEY RECEIVED CASES: AMC394509/\$3100.00	2016 MAINT/10	- n/a -	3100.00
TOTAL:					\$3,100.00

PAYMENT INFORMATION			
1	AMOUNT:	3100.00	POSTMARKED: N/A
	TYPE:	CHECK	RECEIVED: 08/28/2015
	CHECK NO:	180	
	NAME:	NICHOLS, CHARLES WILLIAM 26134 N 93RD AVE PEORIA AZ 85383-1350 US	

REMARKS

This receipt was generated by the automated BLM Collections and Billing System and is a paper representation of a portion of the official electronic record contained therein.

[Handwritten Signature]

UNITED STATES
DEPARTMENT OF THE INTERIOR
BUREAU OF LAND MANAGEMENT
MAINTENANCE FEE PAYMENT FORM
FOR PLACER MINING CLAIMS

AMC 384793 AMC 397074
394051 398944
394491 398962
394513 403058

Remitter Name: C. William & Marianne J. Nichols
Mailing Address: 26134 N. 93rd Ave.
City, State, Zip: Peoria, AZ 85383

396284 403665
396392 410302

Check here if this is a change of address.

FOR COUNTY RECORDER'S USE

No. of claims 10
Total due BLM \$ 3100.00

- The maintenance fee may be paid by cash, check, money order, Bureau of Land Management (BLM) Declining Deposit Account, or credit card (VISA, American Express, Discover, or MasterCard). Payments must be remitted to the BLM State Office where your claim or site is recorded and received on or before September 1. If the payment is mailed, the envelope must be postmarked by a bona fide delivery service on or before September 1 and received at the proper BLM State Office within 15 calendar days after the due date. Payments may also be made by telephone using a credit card. A complete listing of BLM State Offices with their addresses and phone numbers can be found at <http://www.blm.gov>.
- The maintenance fee for the following claim(s) applies to the assessment year 2015.

CLAIM NAME	BLM SERIAL NO.	ACRES IN CLAIM	PAYMENT DUE TO THE BLM (See Instructions on Page 2)
Sila Mountain #36	AMC 394509	40	310.00
Sila Mountain #37	AMC 394509	40	310.00
Sila Mountain #38	AMC 394511	40	310.00
Sila Mountain #39	AMC 394512	40	310.00
Sila Mountain #40	AMC 394051	40	310.00
Sila Mountain #41	AMC ³⁹⁴⁵¹³ 394513	40	310.00
Sila Mountain #42	AMC 396284	40	310.00
Sila Mountain #43	AMC 396285	40	310.00
Sila Mountain #44	AMC 397074	40	310.00
Sila Mountain #45	AMC 397075	40	310.00

Use a separate sheet for additional claim names, serial numbers, and claimant names and addresses.

(Continued on page 2)

ENTERED
AUG 28 2014
PB

RECEIVED
BLM AZ STATE OFFICE
PHOENIX, ARIZONA

2014 AUG 25 P 2:00

UNITED STATES
DEPARTMENT OF THE INTERIOR
BUREAU OF LAND MANAGEMENT

**MAINTENANCE FEE PAYMENT FORM FOR
LODE CLAIMS, MILL SITES, AND TUNNEL SITES**

Remitter Name: C. William +
Marcelline J. Nichols
Mailing Address: 26134 N. 93rd Ave.
City, State, Zip: Peoria, AZ 85383

Check here if this is a change of address.

FOR COUNTY RECORDER'S USE

No. of claims/sites 10
x \$/55 per claim/site
Total due BLM \$ 1550.00

- The maintenance fee may be paid by cash, check, money order, Bureau of Land Management (BLM) Declining Deposit Account, or credit card (VISA, American Express, Discover, or MasterCard). Payments must be remitted to the BLM State Office where your claim or site is recorded and received on or before September 1. If the payment is mailed, the envelope must be postmarked by a bona fide delivery service on or before September 1 and received at the proper BLM State Office within 15 calendar days after the due date. Payments may also be made by telephone using a credit card. A complete listing of BLM State Offices with their addresses and phone numbers can be found at <http://www.blm.gov>.
- The maintenance fee for the following claim(s)/site(s) applies to the assessment year 2015.

CLAIM/SITE NAME	BLM SERIAL NO.
Picacho #1	AMC 403665
Picacho #2	AMC 403666
Hila Mountain #1	AMC 396392
Sunset #1	AMC 398948
Sunset #2	AMC 398949
Sunset #3	AMC 398950
Sunset #4	AMC 398962
Sunset #5	AMC 398963
Sunset #6	AMC 398964
Sunset #7	AMC 398951

Use a separate sheet for additional claim/site names, serial numbers, and claimant names and addresses.

RECEIVED
BLM AZ STATE OFFICE
AUG 25 P 2:00

UNITED STATES
 DEPARTMENT OF THE INTERIOR
 BUREAU OF LAND MANAGEMENT
**MAINTENANCE FEE PAYMENT FORM FOR
 LOSE CLAIMS, MILL SITES, AND TUNNEL SITES**

Remitter Name: C. William +
 Marcilline J Nichols
 Mailing Address: 26134 N. 93rd Ave
 City, State, Zip: Peoria, AZ 85383

Check here if this is a change of address.

FOR COUNTY RECORDER'S USE

No. of claims/sites 5
 x \$ 15.5 per claim/site
 Total due BLM \$ 775.00

- The maintenance fee may be paid by cash, check, money order, Bureau of Land Management (BLM) Declining Deposit Account, or credit card (VISA, American Express, Discover, or MasterCard). Payments must be remitted to the BLM State Office where your claim or site is recorded and received on or before September 1. If the payment is mailed, the envelope must be postmarked by a bona fide delivery service on or before September 1 and received at the proper BLM State Office within 15 calendar days after the due date. Payments may also be made by telephone using a credit card. A complete listing of BLM State Offices with their addresses and phone numbers can be found at <http://www.blm.gov>.
- The maintenance fee for the following claim(s)/site(s) applies to the assessment year 2015.

CLAIM/SITE NAME	BLM SERIAL NO.
<u>Sunset #8</u>	<u>AMC 398952</u>
<u>Sunset #9</u>	<u>AMC 398953</u>
<u>Sunset #10</u>	<u>AMC 398954</u>
<u>Sunset #11</u>	<u>AMC 398955</u>
<u>Cordes Mountain #1</u>	<u>AMC 410302</u>

Use a separate sheet for additional claim/site names, serial numbers, and claimant names and addresses.

RECEIVED
 M AZ STATE OFFICE
 2014 AUG 25 P 2:00
 PHOENIX, ARIZONA

UNITED STATES
DEPARTMENT OF THE INTERI
BUREAU OF LAND MANAGEMENT
**MAINTENANCE FEE PAYMENT FORM
FOR PLACER MINING CLAIMS**

Remitter Name: C. William +
Marcelline J. Nichols
Mailing Address: 26134 N. 93rd Ave
City, State, Zip: Peoria, AZ 85383

Check here if this is a change of address.

FOR COUNTY RECORDER'S USE

No. of claims 5
Total due BLM \$ 1,550.00

1. The maintenance fee may be paid by cash, check, money order, Bureau of Land Management (BLM) Declining Deposit Account, or credit card (VISA, American Express, Discover, or MasterCard). Payments must be remitted to the BLM State Office where your claim or site is recorded and received on or before September 1. If the payment is mailed, the envelope must be postmarked by a bona fide delivery service on or before September 1 and received at the proper BLM State Office within 15 calendar days after the due date. Payments may also be made by telephone using a credit card. A complete listing of BLM State Offices with their addresses and phone numbers can be found at <http://www.blm.gov>.
2. The maintenance fee for the following claim(s) applies to the assessment year 2015.

CLAIM NAME	BLM SERIAL NO.	ACRES IN CLAIM	PAYMENT DUE TO THE BLM (See Instructions on Page 2)
<u>Sila Mountain #46</u>	<u>AMC 397076</u>	<u>40</u>	<u>310.00</u>
<u>Sila Mountain #47</u>	<u>AMC 398944</u>	<u>40</u>	<u>310.00</u>
<u>Sila Mountain #48</u>	<u>AMC 398945</u>	<u>40</u>	<u>310.00</u>
<u>Sila Mountain #49</u>	<u>AMC 398946</u>	<u>40</u>	<u>310.00</u>
<u>Sila Mountain #50</u>	<u>AMC 398947</u>	<u>40</u>	<u>310.00</u>

PHOENIX ARIZONA

Use a separate sheet for additional claim names, serial numbers, and claimant names and addresses.

RECEIVED
BLM AZ STATE OFFICE
00-7-0167-001 W

UNITED STATES
DEPARTMENT OF THE INTERIOR
BUREAU OF LAND MANAGEMENT
MAINTENANCE FEE PAYMENT FORM
FOR PLACER MINING CLAIMS

Remitter Name: d William & Marianne J Nichols
Mailing Address: 26134 N. 93rd Ave.
City, State, Zip: Peoria, AZ 85383

Check here if this is a change of address.

FOR COUNTY RECORDER'S USE

No. of claims 10
Total due BLM \$ 3,100.00

1. The maintenance fee may be paid by cash, check, money order, Bureau of Land Management (BLM) Declining Deposit Account, or credit card (VISA, American Express, Discover, or MasterCard). Payments must be remitted to the BLM State Office where your claim or site is recorded and received on or before September 1. If the payment is mailed, the envelope must be postmarked by a bona fide delivery service on or before September 1 and received at the proper BLM State Office within 15 calendar days after the due date. Payments may also be made by telephone using a credit card. A complete listing of BLM State Offices with their addresses and phone numbers can be found at <http://www.blm.gov>.

2. The maintenance fee for the following claim(s) applies to the assessment year 2015.

CLAIM NAME	BLM SERIAL NO.	ACRES IN CLAIM	PAYMENT DUE TO THE BLM (See Instructions on Page 2)
<u>Sila Mountain #26</u>	<u>AMC 394499</u>	<u>40</u>	<u>310.00</u>
<u>Sila Mountain #27</u>	<u>AMC 394500</u>	<u>40</u>	<u>310.00</u>
<u>Sila Mountain #28</u>	<u>AMC 394501</u>	<u>40</u>	<u>310.00</u>
<u>Sila Mountain #29</u>	<u>AMC 394502</u>	<u>40</u>	<u>310.00</u>
<u>Sila Mountain #30</u>	<u>AMC 394503</u>	<u>40</u>	<u>310.00</u>
<u>Sila Mountain #31</u>	<u>AMC 394504</u>	<u>40</u>	<u>310.00</u>
<u>Sila Mountain #32</u>	<u>AMC 394505</u>	<u>40</u>	<u>310.00</u>
<u>Sila Mountain #33</u>	<u>AMC 394506</u>	<u>40</u>	<u>310.00</u>
<u>Sila Mountain #34</u>	<u>AMC 394507</u>	<u>40</u>	<u>310.00</u>
<u>Sila Mountain #35</u>	<u>AMC 394508</u>	<u>40</u>	<u>310.00</u>

Use a separate sheet for additional claim names, serial numbers, and claimant names and addresses.

RECEIVED
M AZ STATE OFFICE
PHOENIX, ARIZONA
AUG 25 P 2:00

UNITED STATES
DEPARTMENT OF THE INTERIOR
BUREAU OF LAND MANAGEMENT
**MAINTENANCE FEE PAYMENT FORM
FOR PLACER MINING CLAIMS**

Remitter Name: C. William +
Marcelline J Nichols
Mailing Address: 26134 N. 93rd Ave.
City, State, Zip: Peoria, AZ 85383

Check here if this is a change of address.

FOR COUNTY RECORDER'S USE

No. of claims 10
Total due BLM \$ 3,100.00

- The maintenance fee may be paid by cash, check, money order, Bureau of Land Management (BLM) Declining Deposit Account, or credit card (VISA, American Express, Discover, or MasterCard). Payments must be remitted to the BLM State Office where your claim or site is recorded and received on or before September 1. If the payment is mailed, the envelope must be postmarked by a bona fide delivery service on or before September 1 and received at the proper BLM State Office within 15 calendar days after the due date. Payments may also be made by telephone using a credit card. A complete listing of BLM State Offices with their addresses and phone numbers can be found at <http://www.blm.gov>.
- The maintenance fee for the following claim(s) applies to the assessment year 2015.

CLAIM NAME	BLM SERIAL NO.	ACRES IN CLAIM	PAYMENT DUE TO THE BLM (See Instructions on Page 2)
<u>Sila Mountain #16</u>	<u>AMC 384807</u>	<u>40</u>	<u>310.00</u>
<u>Sila Mountain #17</u>	<u>AMC 384808</u>	<u>40</u>	<u>310.00</u>
<u>Sila Mountain #18</u>	<u>AMC 394491</u>	<u>40</u>	<u>310.00</u>
<u>Sila Mountain #19</u>	<u>AMC 394492</u>	<u>40</u>	<u>310.00</u>
<u>Sila Mountain #20</u>	<u>AMC 394493</u>	<u>40</u>	<u>310.00</u>
<u>Sila Mountain #21</u>	<u>AMC 394494</u>	<u>40</u>	<u>310.00</u>
<u>Sila Mountain #22</u>	<u>AMC 394495</u>	<u>40</u>	<u>310.00</u>
<u>Sila Mountain #23</u>	<u>AMC 394496</u>	<u>40</u>	<u>310.00</u>
<u>Sila Mountain #24</u>	<u>AMC 394497</u>	<u>40</u>	<u>310.00</u>
<u>Sila Mountain #25</u>	<u>AMC 394498</u>	<u>40</u>	<u>310.00</u>

Use a separate sheet for additional claim names, serial numbers, and claimant names and addresses.

RECEIVED
BLM AZ STATE OFFICE
PHOENIX, ARIZONA
AUG 25 2015

UNITED STATES
DEPARTMENT OF THE INTERIOR
BUREAU OF LAND MANAGEMENT
**MAINTENANCE FEE PAYMENT FORM
FOR PLACER MINING CLAIMS**

Remitter Name: C William +
Mariline J Nichols
Mailing Address: 26134 N. 93rd Ave.
City, State, Zip: Peoria, AZ 85383

Check here if this is a change of address.

FOR COUNTY RECORDER'S USE

No. of claims 10
Total due BLM \$ 3,100.00

1. The maintenance fee may be paid by cash, check, money order, Bureau of Land Management (BLM) Declining Deposit Account, or credit card (VISA, American Express, Discover, or MasterCard). Payments must be remitted to the BLM State Office where your claim or site is recorded and received on or before September 1. If the payment is mailed, the envelope must be postmarked by a bona fide delivery service on or before September 1 and received at the proper BLM State Office within 15 calendar days after the due date. Payments may also be made by telephone using a credit card. A complete listing of BLM State Offices with their addresses and phone numbers can be found at <http://www.blm.gov>.

2. The maintenance fee for the following claim(s) applies to the assessment year 2015.

CLAIM NAME	BLM SERIAL NO.	ACRES IN CLAIM	PAYMENT DUE TO THE BLM (See Instructions on Page 2)
<u>Sila Mountain #6</u>	<u>AMC 384797</u>	<u>40</u>	<u>310.00</u>
<u>Sila Mountain #7</u>	<u>AMC 384798</u>	<u>40</u>	<u>310.00</u>
<u>Sila Mountain #8</u>	<u>AMC 384799</u>	<u>40</u>	<u>310.00</u>
<u>Sila Mountain #9</u>	<u>AMC 384800</u>	<u>40</u>	<u>310.00</u>
<u>Sila Mountain #10</u>	<u>AMC 384801</u>	<u>40</u>	<u>310.00</u>
<u>Sila Mountain #11</u>	<u>AMC 384802</u>	<u>40</u>	<u>310.00</u>
<u>Sila Mountain #12</u>	<u>AMC 384803</u>	<u>40</u>	<u>310.00</u>
<u>Sila Mountain #13</u>	<u>AMC 384804</u>	<u>40</u>	<u>310.00</u>
<u>Sila Mountain #14</u>	<u>AMC 384805</u>	<u>40</u>	<u>310.00</u>
<u>Sila Mountain #15</u>	<u>AMC 384806</u>	<u>40</u>	<u>310.00</u>

Use a separate sheet for additional claim names, serial numbers, and claimant names and addresses.

RECEIVED
BLM AZ STATE OFFICE
10 25 2014 AUG 25 P 2:01

UNITED STATES
DEPARTMENT OF THE INTERIOR
BUREAU OF LAND MANAGEMENT
MAINTENANCE FEE PAYMENT FORM
FOR PLACER MINING CLAIMS

Remitter Name: C. William +
Marcelline J. Nichols
Mailing Address: 26134 N. 93rd Ave.
City, State, Zip: Peoria, Az. 85383

Check here if this is a change of address.

FOR COUNTY RECORDER'S USE

No. of claims 10
Total due BLM \$ 3100.00

- The maintenance fee may be paid by cash, check, money order, Bureau of Land Management (BLM) Declining Deposit Account, or credit card (VISA, American Express, Discover, or MasterCard). Payments must be remitted to the BLM State Office where your claim or site is recorded and received on or before September 1. If the payment is mailed, the envelope must be postmarked by a bona fide delivery service on or before September 1 and received at the proper BLM State Office within 15 calendar days after the due date. Payments may also be made by telephone using a credit card. A complete listing of BLM State Offices with their addresses and phone numbers can be found at <http://www.blm.gov>.
- The maintenance fee for the following claim(s) applies to the assessment year 2015.

CLAIM NAME	BLM SERIAL NO.	ACRES IN CLAIM	PAYMENT DUE TO THE BLM (See Instructions on Page 2)
<u>Cordes Peak #1</u>	<u>AMC 410303</u>	<u>40</u>	<u>310.00</u>
<u>Cordes Peak #2</u>	<u>AMC 410304</u>	<u>40</u>	<u>310.00</u>
<u>Estrella #1</u>	<u>AMC 384793</u>	<u>40</u>	<u>310.00</u>
<u>Estrella #2</u>	<u>AMC 384794</u>	<u>40</u>	<u>310.00</u>
<u>Estrella #3</u>	<u>AMC 384795</u>	<u>40</u>	<u>310.00</u>
<u>Estrella #4</u>	<u>AMC 384796</u>	<u>40</u>	<u>310.00</u>
<u>Hila Mountain #1</u>	<u>AMC 403058</u>	<u>40</u>	<u>310.00</u>
<u>Hila Mountain #2</u>	<u>AMC 403059</u>	<u>40</u>	<u>310.00</u>
<u>Hila Mountain #3</u>	<u>AMC 403060</u>	<u>40</u>	<u>310.00</u>
<u>Hila Mountain #4</u>	<u>AMC 403061</u>	<u>40</u>	<u>310.00</u>

Use a separate sheet for additional claim names, serial numbers, and addresses.

RECEIVED
MAY 25 2 04 PM '15
PHOENIX, ARIZONA

MINING CLAIMS

MC Customer Information - With Serial No. and Claim Name
ACTIVE CLAIMS

Admin State: AZ

Geo State: AZ

(12) Lead #s

NICHOLS CHARLES WILLIAM
26134 N 93RD AVE
PEORIA, AZ 85383-1350

CUSTOMER ID: 2256028

<u>Serial No.</u>	<u>Claim Name/Number</u>	<u>Lead Serial No.</u>	<u>Disposition</u>
AMC384793 ✓	ESTRELLA 1	AMC384793	ACTIVE
AMC384794 -	ESTRELLA 2	AMC384793	ACTIVE
AMC384795 ✓	ESTRELLA 3	AMC384793	ACTIVE
AMC384796 ✓	ESTRELLA 4	AMC384793	ACTIVE
AMC384797 -	GILA MOUNTAIN 6	AMC384793	ACTIVE
AMC384798 -	GILA MOUNTAIN 7	AMC384793	ACTIVE
AMC384799 -	GILA MOUNTAIN 8	AMC384793	ACTIVE
AMC384800 -	GILA MOUNTAIN 9	AMC384793	ACTIVE
AMC384801 -	GILA MOUNTAIN 10	AMC384793	ACTIVE
AMC384802 -	GILA MOUNTAIN 11	AMC384793	ACTIVE
AMC384803 -	GILA MOUNTAIN 12	AMC384793	ACTIVE
AMC384804 -	GILA MOUNTAIN 13	AMC384793	ACTIVE
AMC384805 -	GILA MOUNTAIN 14	AMC384793	ACTIVE
AMC384806 -	GILA MOUNTAIN 15	AMC384793	ACTIVE
AMC384807 -	GILA MOUNTAIN 16	AMC384793	ACTIVE
AMC384808 ✓	GILA MOUNTAIN 17	AMC384793	ACTIVE
AMC394051 -	GILA MOUNTAIN #40	AMC394051	ACTIVE
AMC394491 ✓	GILA MOUNTAIN #18	AMC394491	ACTIVE
AMC394492 ✓	GILA MOUNTAIN #19	AMC394491	ACTIVE
AMC394493 ✓	GILA MOUNTAIN #20	AMC394491	ACTIVE
AMC394494 -	GILA MOUNTAIN #21	AMC394491	ACTIVE
AMC394495 ✓	GILA MOUNTAIN #22	AMC394491	ACTIVE
AMC394496 -	GILA MOUNTAIN #23	AMC394491	ACTIVE
AMC394497 ✓	GILA MOUNTAIN #24	AMC394491	ACTIVE
AMC394498 -	GILA MOUNTAIN #25	AMC394491	ACTIVE
AMC394499 -	GILA MOUNTAIN #26	AMC394491	ACTIVE
AMC394500 -	GILA MOUNTAIN #27	AMC394491	ACTIVE
AMC394501 ✓	GILA MOUNTAIN #28	AMC394491	ACTIVE
AMC394502 ✓	GILA MOUNTAIN #29	AMC394491	ACTIVE
AMC394503 -	GILA MOUNTAIN #30	AMC394491	ACTIVE
AMC394504 -	GILA MOUNTAIN #31	AMC394491	ACTIVE
AMC394505 ✓	GILA MOUNTAIN #32	AMC394491	ACTIVE
AMC394506 -	GILA MOUNTAIN #33	AMC394491	ACTIVE
AMC394507 ✓	GILA MOUNTAIN #34	AMC394491	ACTIVE
AMC394508 -	GILA MOUNTAIN #35	AMC394491	ACTIVE
AMC394509 ✓	GILA MOUNTAIN #36	AMC394491	ACTIVE
AMC394510 ✓	GILA MOUNTAIN #37	AMC394491	ACTIVE
AMC394511 ✓	GILA MOUNTAIN #38	AMC394491	ACTIVE
AMC394512 ✓	GILA MOUNTAIN #39	AMC394491	ACTIVE
AMC394513 ✓	GILA MOUNTAIN #41	AMC394513	ACTIVE
AMC396284 -	GILA MOUNTAIN #42	AMC396284	ACTIVE
AMC396285 -	GILA MOUNTAIN #43	AMC396284	ACTIVE
AMC396392 ✓	GILA MOUNTAIN LODE 1	AMC396392	ACTIVE
AMC397074 -	GILA MOUNTAIN #44	AMC397074	ACTIVE
AMC397075 -	GILA MOUNTAIN #45	AMC397074	ACTIVE
AMC397076 -	GILA MOUNTAIN #46	AMC397074	ACTIVE
AMC398944 -	GILA MOUNTAIN #47	AMC398944	ACTIVE
AMC398945 ✓	GILA MOUNTAIN #48	AMC398944	ACTIVE

MINING CLAIMS

MC Customer Information - With Serial No. and Claim Name
ACTIVE CLAIMS

<u>Serial No.</u>	<u>Claim Name/Number</u>	<u>Lead Serial No.</u>	<u>Disposition</u>
AMC398946 ✓	GILA MOUNTAIN #49	AMC398944	ACTIVE
AMC398947 ✓	GILA MOUNTAIN #50	AMC398944	ACTIVE
AMC398948 ✓	SUNSET #1	AMC398944	ACTIVE
AMC398949 ✓	SUNSET #2	AMC398944	ACTIVE
AMC398950 ✓	SUNSET #3	AMC398944	ACTIVE
AMC398951 ✓	SUNSET #7	AMC398944	ACTIVE
AMC398952 ✓	SUNSET #8	AMC398944	ACTIVE
AMC398953 ✓	SUNSET #9	AMC398944	ACTIVE
AMC398954 ✓	SUNSET #10	AMC398944	ACTIVE
AMC398955 ✓	SUNSET #11	AMC398944	ACTIVE
AMC398962 ✓	SUNSET #4	AMC398962	ACTIVE
AMC398963 ✓	SUNSET #5	AMC398962	ACTIVE
AMC398964 ✓	SUNSET #6	AMC398962	ACTIVE
AMC403058 ✓	GILA MOUNTAIN #1	AMC403058	ACTIVE
AMC403059 ✓	GILA MOUNTAIN #2	AMC403058	ACTIVE
AMC403060 ✓	GILA MOUNTAIN #3	AMC403058	ACTIVE
AMC403061 ✓	GILA MOUNTAIN #4	AMC403058	ACTIVE
AMC403665 ✓	PICACHO #1	AMC403665	ACTIVE
AMC403666 ✓	PICACHO #2	AMC403665	ACTIVE
AMC410302 ✓	CORDES MOUNTAIN 1	AMC410302	ACTIVE
AMC410303 ✓	CORDES PEAK 1	AMC410302	ACTIVE
AMC410304 ✓	CORDES PEAK 2	AMC410302	ACTIVE

Number of ACTIVE cases: 70

Message:

70 ROWS RETRIEVED

CBS Export Results Report

Include Resolved Records

Record Status

- Error Records (E/M/I)
- Accepted Records (A/W)
- "On Hold" Records (H)
- All Records (for s/n or receipt nr)
- Exported, No Results From CBS
- New (not yet exported)

Search Criteria

Enter export Date (mm/dd/yyyy)

Serial Number match (optional)

Receipt Nr (optional)

Export Nr (exclusive)

LR2000 User (defaults to login)

Query

Responsible Area (Errors Only)

- User (U,X)
- Programmer (P,X)
- All (U,P,X)

Reset

[User Guide](#)

[Printable Format \(legal/landscape\)](#)

	Resend?	Export Nr	A/D	Serial Nr	Multi	Code	\$ Amount	Remarks	Receipt Nr	LR2000 User	#Msg	Resolved?	OK	Stat1	Area	CBS Msg 1	Stat2	Area	Msg 2	CBS 392 ID	392 \$ Amt	Action	Update Date	Resend	Resend Orig	Export Date
1	<input type="checkbox"/>	4713884	A	AMC384793	782	310.00	2015;S310	3111385	PAULINEB			<input type="checkbox"/>								2086294	19375.00	8/28/2014 13:01				
2	<input type="checkbox"/>	4713885	A	AMC384794	782	310.00	2015;S310	3111385	PAULINEB			<input type="checkbox"/>								2086294	19375.00	8/28/2014 13:01				
3	<input type="checkbox"/>	4713886	A	AMC384795	782	310.00	2015;S310	3111385	PAULINEB			<input type="checkbox"/>								2086294	19375.00	8/28/2014 13:01				
4	<input type="checkbox"/>	4713887	A	AMC384796	782	310.00	2015;S310	3111385	PAULINEB			<input type="checkbox"/>								2086294	19375.00	8/28/2014 13:01				
5	<input type="checkbox"/>	4713888	A	AMC384797	782	310.00	2015;S310	3111385	PAULINEB			<input type="checkbox"/>								2086294	19375.00	8/28/2014 13:01				
6	<input type="checkbox"/>	4713889	A	AMC384798	782	310.00	2015;S310	3111385	PAULINEB			<input type="checkbox"/>								2086294	19375.00	8/28/2014 13:01				
7	<input type="checkbox"/>	4713890	A	AMC384799	782	310.00	2015;S310	3111385	PAULINEB			<input type="checkbox"/>								2086294	19375.00	8/28/2014 13:01				
8	<input type="checkbox"/>	4713891	A	AMC384800	782	310.00	2015;S310	3111385	PAULINEB			<input type="checkbox"/>								2086294	19375.00	8/28/2014 13:01				
9	<input type="checkbox"/>	4713892	A	AMC384801	782	310.00	2015;S310	3111385	PAULINEB			<input type="checkbox"/>								2086294	19375.00	8/28/2014 13:01				
10	<input type="checkbox"/>	4713893	A	AMC384802	782	310.00	2015;S310	3111385	PAULINEB			<input type="checkbox"/>								2086294	19375.00	8/28/2014 13:01				
11	<input type="checkbox"/>	4713894	A	AMC384803	782	310.00	2015;S310	3111385	PAULINEB			<input type="checkbox"/>								2086294	19375.00	8/28/2014 13:01				
12	<input type="checkbox"/>	4713895	A	AMC384804	782	310.00	2015;S310	3111385	PAULINEB			<input type="checkbox"/>								2086294	19375.00	8/28/2014 13:01				
13	<input type="checkbox"/>	4713896	A	AMC384805	782	310.00	2015;S310	3111385	PAULINEB			<input type="checkbox"/>								2086294	19375.00	8/28/2014 13:01				
14	<input type="checkbox"/>	4713897	A	AMC384806	782	310.00	2015;S310	3111385	PAULINEB			<input type="checkbox"/>								2086294	19375.00	8/28/2014 13:01				
15	<input type="checkbox"/>	4713898	A	AMC384807	782	310.00	2015;S310	3111385	PAULINEB			<input type="checkbox"/>								2086294	19375.00	8/28/2014 13:01				
16	<input type="checkbox"/>	4713899	A	AMC384808	782	310.00	2015;S310	3111385	PAULINEB			<input type="checkbox"/>								2086294	19375.00	8/28/2014 13:01				
17	<input type="checkbox"/>	4713920	A	AMC394051	782	310.00	2015;S310	3111385	PAULINEB			<input type="checkbox"/>								2086294	19375.00	8/28/2014 13:02				
18	<input type="checkbox"/>	4713967	A	AMC394491	782	310.00	2015;S310	3111385	PAULINEB			<input type="checkbox"/>								2086294	19375.00	8/28/2014 13:03				
19	<input type="checkbox"/>	4713968	A	AMC394492	782	310.00	2015;S310	3111385	PAULINEB			<input type="checkbox"/>								2086294	19375.00	8/28/2014 13:03				
20	<input type="checkbox"/>	4713969	A	AMC394493	782	310.00	2015;S310	3111385	PAULINEB			<input type="checkbox"/>								2086294	19375.00	8/28/2014 13:03				

United States Department of the Interior
Bureau of Land Management
 LANDS/RECREATION & PLANNING
 ONE N CENTRAL AVE
 PHOENIX, AZ 85004 -2203
 Phone: 602-417-9200

Receipt

No: 3111385

Transaction #: 3203090	ENTERED INTO COMPUTER
Date of Transaction: 08/25/2014	
CUSTOMER:	AUG 28 2014 <i>PB</i>
CWILLIAMS NICHOLS 26134 N 93RD AVE PEORIA, AZ 85383-1350 US	

LINE #	QTY	DESCRIPTION	REMARKS	UNIT PRICE	TOTAL
1	1.00	LOCATABLE MINERALS / MINING CLAIMS- NOT NEW-UNADJUD, ONE AUTH NO. ONLY / MINING CLAIM MONEY RECEIVED CASES: AMC403665/\$19375.00	MAINT (70) 2015	- n/a -	19375.00
TOTAL:					\$19,375.00

PAYMENT INFORMATION			
1	AMOUNT:	19375.00	POSTMARKED: N/A
	TYPE:	CHECK	RECEIVED: 08/25/2014
	CHECK NO:	158	
	NAME:	NICHOLS, CWILLIAMS 26134 N 93RD AVE PEORIA AZ 85383-1350 US	

REMARKS

This receipt was generated by the automated BLM Collections and Billing System and is a paper representation of a portion of the official electronic record contained therein.

William & Marcie Nichols

2014 Maintenance Fee

Lead Files

AMC 384793

394051

394491

394513

396284

396392

397074

398944

398962

403058

403665

410302

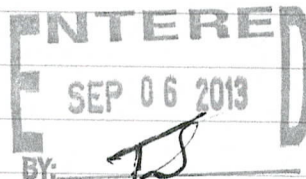

UNITED STATES
DEPARTMENT OF THE INTERIOR
BUREAU OF LAND MANAGEMENT
**MAINTENANCE FEE PAYMENT FORM
FOR PLACER MINING CLAIMS**

Remitter Name: <u>C. William & Marcelline J Nichols</u> Mailing Address: <u>26134 N. 93rd Ave.</u> City, State, Zip: <u>Peoria, AZ 85383</u> <input type="checkbox"/> Check here if this is a change of address.	RECEIVED BLM AZ STATE OFFICE 2013 AUG 29 A 9:51 PHOENIX, ARIZONA FOR COUNTY RECORDER'S USE
---	---

No. of claims 10
 Total due BLM \$ 2800.00

- The maintenance fee may be paid by cash, check, money order, Bureau of Land Management (BLM) Declining Deposit Account, or credit card (VISA, American Express, Discover, or MasterCard). Payments must be remitted to the BLM State Office where your claim or site is recorded and received on or before September 1. If the payment is mailed, the envelope must be postmarked by a bona fide delivery service on or before September 1 and received at the proper BLM State Office within 15 calendar days after the due date. Payments may also be made by telephone using a credit card. A complete listing of BLM State Offices with their addresses and phone numbers can be found at <http://www.blm.gov>.
- The maintenance fee for the following claim(s) applies to the assessment year 2014.

CLAIM NAME	BLM SERIAL NO.	ACRES IN CLAIM	PAYMENT DUE TO THE BLM (See Instructions on Page 2)
<u>Cordes Peak #1</u>	<u>AMC 410303</u>	<u>40</u>	<u>\$ 280.00</u>
<u>Cordes Peak #2</u>	<u>AMC 410304</u>	<u>40</u>	<u>\$ 280.00</u>
<u>Estrella #1</u>	<u>AMC 384793</u>	<u>40</u>	<u>\$ 280.00</u>
<u>Estrella #2</u>	<u>AMC 384794</u>	<u>40</u>	<u>\$ 280.00</u>
<u>Estrella #3</u>	<u>AMC 384795</u>	<u>40</u>	<u>\$ 280.00</u>
<u>Estrella #4</u>	<u>AMC 384796</u>	<u>40</u>	<u>\$ 280.00</u>
<u>Sila Mountain #1</u>	<u>AMC 403058</u>	<u>40</u>	<u>\$ 280.00</u>
<u>Sila Mountain #2</u>	<u>AMC 403059</u>	<u>40</u>	<u>\$ 280.00</u>
<u>Sila Mountain #3</u>	<u>AMC 403060</u>	<u>40</u>	<u>\$ 280.00</u>
<u>Sila Mountain #4</u>	<u>AMC 403061</u>	<u>40</u>	<u>\$ 280.00</u>

Use a separate sheet for additional claim names, serial numbers, and claimant names and addresses.

2868509 70
JML

UNITED STATES
DEPARTMENT OF THE INTERIOR
BUREAU OF LAND MANAGEMENT
**MAINTENANCE FEE PAYMENT FORM
FOR PLACER MINING CLAIMS**

Remitter Name: C. William & Marcelline J Nichols
 Mailing Address: 26134 N. 93rd Ave.
 City, State, Zip: Peoria Ar 85383

Check here if this is a change of address.

RECEIVED
 LAND STATE OFFICE
 2013 AUG 29 A 9:5
 PHOENIX, ARIZONA
FOR COUNTY RECORDER'S USE

No. of claims 10
 Total due BLM \$ 2800 00

- The maintenance fee may be paid by cash, check, money order, Bureau of Land Management (BLM) Declining Deposit Account, or credit card (VISA, American Express, Discover, or MasterCard). Payments must be remitted to the BLM State Office where your claim or site is recorded and received on or before September 1. If the payment is mailed, the envelope must be postmarked by a bona fide delivery service on or before September 1 and received at the proper BLM State Office within 15 calendar days after the due date. Payments may also be made by telephone using a credit card. A complete listing of BLM State Offices with their addresses and phone numbers can be found at <http://www.blm.gov>.
- The maintenance fee for the following claim(s) applies to the assessment year 2014.

CLAIM NAME	BLM SERIAL NO.	ACRES IN CLAIM	PAYMENT DUE TO THE BLM (See Instructions on Page 2)
<u>Sila Mountain #6</u>	<u>AMC 384797</u>	<u>40</u>	<u>280 00</u>
<u>Sila Mountain #7</u>	<u>AMC 384798</u>	<u>40</u>	<u>280 00</u>
<u>Sila Mountain #8</u>	<u>AMC 384799</u>	<u>40</u>	<u>280 00</u>
<u>Sila Mountain #9</u>	<u>AMC 384800</u>	<u>40</u>	<u>280 00</u>
<u>Sila Mountain #10</u>	<u>AMC 384801</u>	<u>40</u>	<u>280 00</u>
<u>Sila Mountain #11</u>	<u>AMC 384802</u>	<u>40</u>	<u>280 00</u>
<u>Sila Mountain #12</u>	<u>AMC 384803</u>	<u>40</u>	<u>280 00</u>
<u>Sila Mountain #13</u>	<u>AMC 384804</u>	<u>40</u>	<u>280 00</u>
<u>Sila Mountain #14</u>	<u>AMC 384805</u>	<u>40</u>	<u>280 00</u>
<u>Sila Mountain #15</u>	<u>AMC 384806</u>	<u>40</u>	<u>280 00</u>

Use a separate sheet for additional claim names, serial numbers, and claimant names and addresses.

UNITED STATES
DEPARTMENT OF THE INTERIOR
BUREAU OF LAND MANAGEMENT
**MAINTENANCE FEE PAYMENT FORM
FOR PLACER MINING CLAIMS**

Remitter Name: C. William +
Marcelline J Nichols

Mailing Address: 26134 N. 93rd Ave.

City, State, Zip: Peoria Ar 85383

Check here if this is a change of address.

RECEIVED
BLM AZ OFFICE
AUG 29 A 9:51
PHOENIX, ARIZONA

FOR COUNTY RECORDER'S USE

No. of claims 10
Total due BLM \$ 2800.00

- The maintenance fee may be paid by cash, check, money order, Bureau of Land Management (BLM) Declining Deposit Account, or credit card (VISA, American Express, Discover, or MasterCard). Payments must be remitted to the BLM State Office where your claim or site is recorded and received on or before September 1. If the payment is mailed, the envelope must be postmarked by a bona fide delivery service on or before September 1 and received at the proper BLM State Office within 15 calendar days after the due date. Payments may also be made by telephone using a credit card. A complete listing of BLM State Offices with their addresses and phone numbers can be found at <http://www.blm.gov>.
- The maintenance fee for the following claim(s) applies to the assessment year 2014.

CLAIM NAME	BLM SERIAL NO.	ACRES IN CLAIM	PAYMENT DUE TO THE BLM (See Instructions on Page 2)
<u>Hela Mountain #16</u>	<u>AMC 384807</u>	<u>40</u>	<u>280.00</u>
<u>Hela Mountain #17</u>	<u>AMC 384808</u>	<u>40</u>	<u>280.00</u>
<u>Hela Mountain #18</u>	<u>AMC 394491</u>	<u>40</u>	<u>280.00</u>
<u>Hela Mountain #19</u>	<u>AMC 394492</u>	<u>40</u>	<u>280.00</u>
<u>Hela Mountain #20</u>	<u>AMC 394493</u>	<u>40</u>	<u>280.00</u>
<u>Hela Mountain #21</u>	<u>AMC 394494</u>	<u>40</u>	<u>280.00</u>
<u>Hela Mountain #22</u>	<u>AMC 394495</u>	<u>40</u>	<u>280.00</u>
<u>Hela Mountain #23</u>	<u>AMC 394496</u>	<u>40</u>	<u>280.00</u>
<u>Hela Mountain #24</u>	<u>AMC 394497</u>	<u>40</u>	<u>280.00</u>
<u>Hela Mountain #25</u>	<u>AMC 394498</u>	<u>40</u>	<u>280.00</u>

Use a separate sheet for additional claim names, serial numbers, and claimant names and addresses.

UNITED STATES
DEPARTMENT OF THE INTERIOR
BUREAU OF LAND MANAGEMENT
**MAINTENANCE FEE PAYMENT FORM
FOR PLACER MINING CLAIMS**

Remitter Name: C. Wettern +
Marshall J. Nichols
Mailing Address: 26134 N. 93rd Ave.
City, State, Zip: Peoria Az 85383

Check here if this is a change of address.

RECEIVED
BLM AZ STATE OFFICE
2013 AUG 29 A 9:55
PHOENIX, ARIZONA
FOR COUNTY RECORDER'S USE

No. of claims 10
Total due BLM \$ 2800.00

- The maintenance fee may be paid by cash, check, money order, Bureau of Land Management (BLM) Declining Deposit Account, or credit card (VISA, American Express, Discover, or MasterCard). Payments must be remitted to the BLM State Office where your claim or site is recorded and received on or before September 1. If the payment is mailed, the envelope must be postmarked by a bona fide delivery service on or before September 1 and received at the proper BLM State Office within 15 calendar days after the due date. Payments may also be made by telephone using a credit card. A complete listing of BLM State Offices with their addresses and phone numbers can be found at <http://www.blm.gov>.
- The maintenance fee for the following claim(s) applies to the assessment year 2014.

CLAIM NAME	BLM SERIAL NO.	ACRES IN CLAIM	PAYMENT DUE TO THE BLM (See Instructions on Page 2)
<u>Sila Mountain #26</u>	<u>AMC 394499</u>	<u>40</u>	<u>280.00</u>
<u>Sila Mountain #27</u>	<u>AMC 394500</u>	<u>40</u>	<u>280.00</u>
<u>Sila Mountain #28</u>	<u>AMC 394501</u>	<u>40</u>	<u>280.00</u>
<u>Sila Mountain #29</u>	<u>AMC 394502</u>	<u>40</u>	<u>280.00</u>
<u>Sila Mountain #30</u>	<u>AMC 394503</u>	<u>40</u>	<u>280.00</u>
<u>Sila Mountain #31</u>	<u>AMC 394504</u>	<u>40</u>	<u>280.00</u>
<u>Sila Mountain #32</u>	<u>AMC 394505</u>	<u>40</u>	<u>280.00</u>
<u>Sila Mountain #33</u>	<u>AMC 394506</u>	<u>40</u>	<u>280.00</u>
<u>Sila Mountain #34</u>	<u>AMC 394507</u>	<u>40</u>	<u>280.00</u>
<u>Sila Mountain #35</u>	<u>AMC 394508</u>	<u>40</u>	<u>280.00</u>

Use a separate sheet for additional claim names, serial numbers, and claimant names and addresses.

UNITED STATES
DEPARTMENT OF THE INTERIOR
BUREAU OF LAND MANAGEMENT
**MAINTENANCE FEE PAYMENT FORM
FOR PLACER MINING CLAIMS**

Remitter Name: <u>d. William + Marcelline J Nichols</u> Mailing Address: <u>26134 W. 93rd Ave</u> City, State, Zip: <u>Peoria, AZ 85383</u> <input type="checkbox"/> Check here if this is a change of address.	RECEIVED BLM AZ STATE OFFICE 2013 AUG 29 A 9:11 PHOENIX, ARIZONA FOR COUNTY RECORDER'S USE
--	---

No. of claims 10
 Total due BLM \$ 2800.00

- The maintenance fee may be paid by cash, check, money order, Bureau of Land Management (BLM) Declining Deposit Account, or credit card (VISA, American Express, Discover, or MasterCard). Payments must be remitted to the BLM State Office where your claim or site is recorded and received on or before September 1. If the payment is mailed, the envelope must be postmarked by a bona fide delivery service on or before September 1 and received at the proper BLM State Office within 15 calendar days after the due date. Payments may also be made by telephone using a credit card. A complete listing of BLM State Offices with their addresses and phone numbers can be found at <http://www.blm.gov>.
- The maintenance fee for the following claim(s) applies to the assessment year 2014.

CLAIM NAME	BLM SERIAL NO.	ACRES IN CLAIM	PAYMENT DUE TO THE BLM (See Instructions on Page 2)
<u>Sila Mountain #36</u>	<u>AMC 394509</u>	<u>40</u>	<u>280.00</u>
<u>Sila Mountain #37</u>	<u>AMC 394510</u>	<u>40</u>	<u>280.00</u>
<u>Sila Mountain #38</u>	<u>AMC 394511</u>	<u>40</u>	<u>280.00</u>
<u>Sila Mountain #39</u>	<u>AMC 394512</u>	<u>40</u>	<u>280.00</u>
<u>Sila Mountain #40</u>	<u>AMC 394051</u>	<u>40</u>	<u>280.00</u>
<u>Sila Mountain #41</u>	<u>AMC 394513</u>	<u>40</u>	<u>280.00</u>
<u>Sila Mountain #42</u>	<u>AMC 396284</u>	<u>40</u>	<u>280.00</u>
<u>Sila Mountain #43</u>	<u>AMC 396285</u>	<u>40</u>	<u>280.00</u>
<u>Sila Mountain #44</u>	<u>AMC 397074</u>	<u>40</u>	<u>280.00</u>
<u>Sila Mountain #45</u>	<u>AMC 397075</u>	<u>40</u>	<u>280.00</u>

Use a separate sheet for additional claim names, serial numbers, and claimant names and addresses.

UNITED STATES
DEPARTMENT OF THE INTERIOR
BUREAU OF LAND MANAGEMENT
**MAINTENANCE FEE PAYMENT FORM
FOR PLACER MINING CLAIMS**

<p>Remitter Name: <u>C. William + Marillie J. Nichols</u></p> <p>Mailing Address: <u>26134 N. 93rd Ave</u></p> <p>City, State, Zip: <u>Peoria Az 85383</u></p> <p><input type="checkbox"/> Check here if this is a change of address.</p>	<p>RECEIVED BLM AZ STATE OFFICE 2013 AUG 29 A 9:55 PHOENIX, ARIZONA</p> <p>FOR COUNTY RECORDER'S USE</p>
--	---

No. of claims 5
Total due BLM \$ 1400.00

- The maintenance fee may be paid by cash, check, money order, Bureau of Land Management (BLM) Declining Deposit Account, or credit card (VISA, American Express, Discover, or MasterCard). Payments must be remitted to the BLM State Office where your claim or site is recorded and received on or before September 1. If the payment is mailed, the envelope must be postmarked by a bona fide delivery service on or before September 1 and received at the proper BLM State Office within 15 calendar days after the due date. Payments may also be made by telephone using a credit card. A complete listing of BLM State Offices with their addresses and phone numbers can be found at <http://www.blm.gov>.
- The maintenance fee for the following claim(s) applies to the assessment year 2014.

CLAIM NAME	BLM SERIAL NO.	ACRES IN CLAIM	PAYMENT DUE TO THE BLM (See Instructions on Page 2)
<u>Sila Mountain #46</u>	<u>AMC 397076</u>	<u>40</u>	<u>280⁰⁰</u>
<u>Sila Mountain #47</u>	<u>AMC 398944</u>	<u>40</u>	<u>280⁰⁰</u>
<u>Sila Mountain #48</u>	<u>AMC 398945</u>	<u>40</u>	<u>280⁰⁰</u>
<u>Sila Mountain #49</u>	<u>AMC 398946</u>	<u>40</u>	<u>280⁰⁰</u>
<u>Sila Mountain #50</u>	<u>AMC 398947</u>	<u>40</u>	<u>280⁰⁰</u>

Use a separate sheet for additional claim names, serial numbers, and claimant names and addresses.

UNITED STATES
DEPARTMENT OF THE INTERIOR
BUREAU OF LAND MANAGEMENT
**MAINTENANCE FEE PAYMENT FORM FOR
LODE CLAIMS, MILL SITES, AND TUNNEL SITES**

Remitter Name: C. William +
Marcelline J Nichols
Mailing Address: 26134 N. 93rd Ave.
City, State, Zip: Peoria, AZ 85383

Check here if this is a change of address.

RECEIVED
BLM AZ STATE OFFICE
2013 AUG 29 A 9:51
PHOENIX, ARIZONA

FOR COUNTY RECORDER'S USE

No. of claims/sites 5
x \$140 per claim/site
Total due BLM \$ 700⁰⁰

- The maintenance fee may be paid by cash, check, money order, Bureau of Land Management (BLM) Declining Deposit Account, or credit card (VISA, American Express, Discover, or MasterCard). Payments must be remitted to the BLM State Office where your claim or site is recorded and received on or before September 1. If the payment is mailed, the envelope must be postmarked by a bona fide delivery service on or before September 1 and received at the proper BLM State Office within 15 calendar days after the due date. Payments may also be made by telephone using a credit card. A complete listing of BLM State Offices with their addresses and phone numbers can be found at <http://www.blm.gov>.
- The maintenance fee for the following claim(s)/site(s) applies to the assessment year 2014.

CLAIM/SITE NAME	BLM SERIAL NO.
<u>Sunset #8</u>	<u>AMC 398952</u>
<u>Sunset #9</u>	<u>AMC 398953</u>
<u>Sunset #10</u>	<u>AMC 398954</u>
<u>Sunset #11</u>	<u>AMC 398955</u>
<u>Cordes Mountain #1</u>	<u>AMC 410302</u>

Use a separate sheet for additional claim/site names, serial numbers, and claimant names and addresses.

UNITED STATES
DEPARTMENT OF THE INTERIOR
BUREAU OF LAND MANAGEMENT
**MAINTENANCE FEE PAYMENT FORM FOR
LODE CLAIMS, MILL SITES, AND TUNNEL SITES**

Remitter Name: C. William +
Marcelline J Nichols
Mailing Address: 26134 N. 93rd Ave.
City, State, Zip: Peoria, AZ 85383

Check here if this is a change of address.

RECEIVED
BLM AZ STATE OFFICE
2013 AUG 29 A 9:51
PHOENIX, ARIZONA

FOR COUNTY RECORDER'S USE

No. of claims/sites 10
x \$140 per claim/site
Total due BLM \$ 1,400.00

- The maintenance fee may be paid by cash, check, money order, Bureau of Land Management (BLM) Declining Deposit Account, or credit card (VISA, American Express, Discover, or MasterCard). Payments must be remitted to the BLM State Office where your claim or site is recorded and received on or before September 1. If the payment is mailed, the envelope must be postmarked by a bona fide delivery service on or before September 1 and received at the proper BLM State Office within 15 calendar days after the due date. Payments may also be made by telephone using a credit card. A complete listing of BLM State Offices with their addresses and phone numbers can be found at <http://www.blm.gov>.
- The maintenance fee for the following claim(s)/site(s) applies to the assessment year 2014.

CLAIM/SITE NAME	BLM SERIAL NO.
Picacho #1	AMC 403665
Picacho #1	AMC 403666
Dila Mountain Lode #1	AMC 396392
Sunset #1	AMC 398948
Sunset #2	AMC 398949
Sunset #3	AMC 398950
Sunset #4	AMC 398962
Sunset #5	AMC 398963
Sunset #6	AMC 398964
Sunset #7	AMC 398951

Use a separate sheet for additional claim/site names, serial numbers, and claimant names and addresses.

United States Department of the Interior
 Bureau of Land Management
 LANDS/RECREATION & PLANNING
 ONE N CENTRAL AVE
 PHOENIX, AZ 85004 -2203
 Phone: 602-417-9200

Receipt

No:

2868509

Transaction #: 2954469	
Date of Transaction: 08/29/2013	
CUSTOMER:	
CHARLES WILLIAM NICHOLS 26134 N 93RD AVE PEORIA, AZ 85383-1350 US	

LINE #	QTY	DESCRIPTION	REMARKS	UNIT PRICE	TOTAL
1	1.00	LOCATABLE MINERALS / MINING CLAIMS-NOT NEW-UNADJUD, ONE AUTH NO. ONLY / MINING CLAIM MONEY RECEIVED CASES: AMC410303/\$17500.00	MAINT 2014/70	- n/a -	17500.00
TOTAL:					\$17,500.00

PAYMENT INFORMATION			
1	AMOUNT:	17500.00	POSTMARKED: N/A
	TYPE:	CHECK	RECEIVED: 08/29/2013
	CHECK NO:	142	
	NAME:	NICHOLS, CHARLES WILLIAM 26134 N 93RD AVE PEORIA AZ 85383-1350 US	

REMARKS

This receipt was generated by the automated BLM Collections and Billing System and is a paper representation of a portion of the official electronic record contained therein.

Amc 410 502
~~Amc 398944~~
 Amc 398944
 Amc 398962
 Amc 403058
 Amc 403665
 Amc 396392

Amc 384793
 Amc 394513
 Amc 394491
 Amc 394051
 Amc 396284
 Amc 397074

MAINTENANCE FEE PAYMENT

Claimant Name: C. William & Marjellene J. Nichols
 Address: 26134 N. 93rd Ave.
 City: Peoria State: AZ Zip: 85383
 Telephone: 623-376-8045
 E-mail address: mjcwnichols@msw.com
 Signature: Marjellene Nichols

Check here if this is a change of address.

RECEIVED
 BLM AZ STATE OFFICE
 2012 AUG 29 P 1:26
 PHOENIX, ARIZONA
 BLM
 Date
 Stamp

LINE NO.	AMC NUMBER	CLAIM/SITE NAME	COUNTY RECORDER DATA (If available)	TWP	RNG	SEC
1	384797	Hila Mountain #6	2007-0821533	2S	4W	12
2	384798	Hila Mountain #7	2007-0821534	2S	4W	12
3	384799	Hila Mountain #8	2007-0821585	2S	4W	12
4	384800	Hila Mountain #9	2007-0821536	2S	4W	12
5	384801	Hila Mountain #10	2007-0821537	2S	4W	12
6	384802	Hila Mountain #11	2007-0821538	2S	4W	13
7	384803	Hila Mountain #12	2007-0821539	2S	4W	13
8	384804	Hila Mountain #13	2007-0821540	2S	4W	13
9	384805	Hila Mountain #14	2007-0821541	2S	4W	13
10	384806	Hila Mountain #15	2007-0821542	2S	4W	13

List additional claims on Form MCF114.

No. of Claims: 45 x \$140 = 6300
 Check No: 23917 Init. SC
 Receipt No.: 2644202
 For BLM Use Only

Bureau of Land Management
 Arizona State Office
 www.blm.gov/az/

15 Lodes
 55 40 acre places

This form is available from the Arizona Department of Mines and Mineral Resources and may be reproduced.

55 x \$140 = ~~\$7,700~~ due

55 x 230 = 12,650 - 7,700 (pd) = \$4,950 due

pd \$7,700 11/15/12 AT

ENTERED INTO COMPUTER

9/11/12 AT

Form: MCF112
 Revised July 2009

SUPPLEMENTAL ATTACHMENT

May be used with the following forms for listing additional mining claims:

Check One.

- Affidavit of Performance of Annual Work
- Maintenance Fee Payment
- Notice of Intent to Hold Mining Claims
- Notice of Non-Liability for Labor and Materials Furnished

BLM
Date
Stamp

RECEIVED
BLM AZ STATE OFFICE
PHOENIX, ARIZONA
JUN 20 2007
1:25 PM

LINE NO.	AMC NUMBER	CLAIM/SITE NAME	COUNTY RECORDER DATA (If available)	TWP	RANG	SEC
40 11	384807	Hila Mountain #16	2007-0821543	2S	4W	13
40 12	384808	Hila Mountain #17	2007-0821544	2S	4W	13
40 13	394491	Hila Mountain #18	2008-0734873	2S	4W	1
40 14	394492	Hila Mountain #19	2008-0734874	2S	4W	12
40 15	394493	Hila Mountain #20	2008-0734875	2S	4W	12
40 16	394494	Hila Mountain #21	2008-0734876	2S	4W	12
40 17	394495	Hila Mountain #22	2008-0734877	2S	4W	12
40 18	394496	Hila Mountain #23	2008-0734878	2S	4W	12
40 19	394497	Hila Mountain #24	2008-0734879	2S	4W	12
40 20	394498	Hila Mountain #25	2008-0734880	2S	4W	12
40 21	394499	Hila Mountain #26	2008-0734881	2S	4W	12
40 22	394500	Hila Mountain #27	2008-0734882	2S	4W	12
40 23	394501	Hila Mountain #28	2008-0734882	2S	4W	12
40 24	394502	Hila Mountain #29	2008-0734884	2S	4W	12
40 25	394503	Hila Mountain #30	2008-0734885	2S	4W	1
40 26	394504	Hila Mountain #31	2008-0734886	2S	4W	1
40 27	394505	Hila Mountain #32	2008-0734887	2S	4W	12
40 28	394506	Hila Mountain #33	2008-0734888	2S	4W	1
40 29	394507	Hila Mountain #34	2008-0734889	2S	4W	1

Form MCF114
Revised June 2005

SUPPLEMENTAL ATTACHMENT

May be used with the following forms for listing additional mining claims:

Check One.

- Affidavit of Performance of Annual Work
- Maintenance Fee Payment
- Notice of Intent to Hold Mining Claims
- Notice of Non-Liability for Labor and Materials Furnished

RECEIVED
 BLM AZ STATE OFFICE
 2012 AUG 29 P 1:26
 PHOENIX, ARIZONA
 BLM
 Date
 Stamp

LINE NO.	AMC NUMBER	CLAIM/SITE NAME	COUNTY RECORDER DATA (if available)	TWP	RNG	SEC
40	394508	Hila Mountain #35	2008-0734890	2S	4W	1
40	394509	Hila Mountain #36	2008-0734891	2S	4W	1
40	394510	Hila Mountain #37	2008-0734892	2S	4W	1
40	394511	Hila Mountain #38	2008-0734893	2S	4W	1
40	394512	Hila Mountain #39	2008-0734894	2S	4W	13
40	394051	Hila Mountain #40	2008-0686416	2S	3W	7
40	394513	Hila Mountain #41	2008-0737568	2S	4W	1
40	396284	Hila Mountain #42	2009-0214882	2S	3W	6
40	396285	Hila Mountain #43	2009-0214883	2S	3W	6
40	397074	Hila Mountain #44	2009-0635328	2S	3W	6
40	397075	Hila Mountain #45	2009-0635329	2S	3W	6
40	397076	Hila Mountain #46	2009-0635330	2S	3W	7
40	398944	Hila Mountain #47	2009-1150818	1S	4W	25
40	398945	Hila Mountain #48	2009-1150819	1S	4W	25
40	398946	Hila Mountain #49	2009-1150820	1S	4W	25
40	398947	Hila Mountain #50	2009-1150821	1S	4W	25

Form MCF114
 Revised June 2005

MAINTENANCE FEE PAYMENT

Claimant Name: C. William + Marcelline J. Nichols
 Address: 26134 N. 93rd Ave.
 City: Pecunia State: AZ Zip: 85383
 Telephone: 623-376-8045
 E-mail address: mjcnichols@msn.com
 Signature: Marcelline J. Nichols

Check here if this is a change of address.

RECEIVED
 BLM AZ STATE OFFICE
 PHOENIX, ARIZONA
 2012 AUG 29 P 1:20
 BLM
 Date
 Stamp

LINE NO.	AMC NUMBER	CLAIM/SITE NAME	COUNTY RECORDER DATA (If available)	TWP	RNG	SEC
1	398948	Sunset #1	2009-1150822	1S	4W	25
2	398949	Sunset #2	2009-1150823	1S	4W	25
3	398950	Sunset #3	2009-1150824	1S	4W	25
4	398962	Sunset #4	2009-1150825	1S	4W	25
5	398963	Sunset #5	2009-1150826	1S	4W	25
6	398964	Sunset #6	2009-1150827	1S	4W	25
7	398951	Sunset #7	2009-1150828	2S	4W	1
8	398952	Sunset #8	2009-1150829	2S	4W	1
9	398953	Sunset #9	2009-1150830	2S	4W	1
10	398954	Sunset #10	2009-1150831	2S	4W	1

List additional claims on Form MCF114.

Bureau of Land Management
 Arizona State Office
 www.blm.gov/az/

No. of Claims: 11 x \$140 = 1540
 Check No: 23917 Init. JC
 Receipt No.: 2644202
 For BLM Use Only

Form: MCF112
 Revised July 2009

This form is available from the Arizona Department of Mines and Mineral Resources and may be reproduced.

SUPPLEMENTAL ATTACHMENT

May be used with the following forms for listing additional mining claims:

Check One.

- Affidavit of Performance of Annual Work
- Maintenance Fee Payment
- Notice of Intent to Hold Mining Claims
- Notice of Non-Liability for Labor and Materials Furnished

BLM
Date
Stamp

RECEIVED
 BLM AZ STATE OFFICE
 2012 AUG 29 P 1:26
 PHOENIX, ARIZONA

LINE NO.	AMC NUMBER	CLAIM/SITE NAME	COUNTY RECORDER DATA (If available)	TWP	RNG	SEC
11	398955	Sunset #11	2009-1150832	2S	4W	1

MAINTENANCE FEE PAYMENT

Claimant Name: C. William + Marcelline J Nichols
 Address: 26134 N. 93rd Ave.
 City: Peoria State: AZ Zip: 85383
 Telephone: 623-376-8045
 E-mail address: mjwnichols@msu.com
 Signature: Marcelline J Nichols

Check here if this is a change of address.

RECEIVED
 BLM AZ STATE OFFICE
 2012 AUG 29 P 1:26
 PHOENIX, ARIZONA
 BLM
 Date
 Stamp

40
40
40
40

LINE NO.	AMC NUMBER	CLAIM/SITE NAME	COUNTY RECORDER DATA (If available)	TWP	RNG	SEC
1	403058	Hila Mountain #1	2010-1013786	2S	4W	1
2	403059	Hila Mountain #2	2010-1013787	2S	4W	1
3	403060	Hila Mountain #3	2010-1013788	2S	4W	1
4	403061	Hila Mountain #4	2010-1013789	2S	4W	1
5						
6						
7						
8						
9						
10						

List additional claims on Form MCF114.

Bureau of Land Management
 Arizona State Office
 www.blm.gov/az

No. of Claims: 4 x \$140 = 560
 Check No: 23917 Init. SC
 Receipt No.: 2644202
 For BLM Use Only

Form: MCF112
 Revised July 2009

This form is available from the Arizona Department of Mines and Mineral Resources and may be reproduced.

MAINTENANCE FEE PAYMENT

Claimant Name: C. William + Marjillene J. Nichols
 Address: 26134 N. 93rd Ave.
 City: Peoria State: Az Zip: 85383
 Telephone: 623-376-8045
 E-mail address: mjnw@nichols@msa.com
 Signature: Marjillene J. Nichols

Check here if this is a change of address.

RECEIVED
 BLM AZ STATE OFFICE
 2012 AUG 29 P 1:26
 PHOENIX, ARIZONA
 BLM
 Date
 Stamp

LINE NO.	AMC NUMBER	CLAIM/SITE NAME	COUNTY RECORDER DATA (If available)	TWP	RNG	SEC
1	403665	Peiacho #1 ^{Lode}	2010-4433549	7N	2W	21
2	403666	Peiacho #2 ^{Lode}	2010-4433550	7N	2W	21
3						
4						
5						
6						
7						
8						
9						
10						

List additional claims on Form MCF114.

Bureau of Land Management
 Arizona State Office
 www.blm.gov/az/

No. of Claims: 2 x \$140 = 280
 Check No: 23917 Init. SC
 Receipt No.: 2644202
 For BLM Use Only

Form: MCF112
 Revised July 2009

This form is available from the Arizona Department of Mines and Mineral Resources and may be reproduced.

MAINTENANCE FEE PAYMENT

Claimant Name: C. William & Marcelline J. Nichols
 Address: 26134 N. 93rd Ave.
 City: Peoria State: AZ Zip: 85383
 Telephone: 623-376-8045
 E-mail address: mjcwnichols@msn.com
 Signature: Marcelline J. Nichols

Check here if this is a change of address.

RECEIVED
 BLM AZ STATE OFFICE
 2012 AUG 29 P 1:26
 PHOENIX, ARIZONA
 BLM
 Date
 Stamp

LINE NO.	AMC NUMBER	CLAIM/SITE NAME	COUNTY RECORDER DATA (If available)	TWP	RNG	SEC
1	396392	Hila Mountain ^{code} #1	2009-0295666	2S	3W	6
2						
3						
4						
5						
6						
7						
8						
9						
10						

List additional claims on Form MCF114.

No. of Claims: 1 x \$140 = 140
 Check No: 23917 Init. SC
 Receipt No.: 2644202
 For BLM Use Only

Bureau of Land Management
 Arizona State Office
 www.blm.gov/az/

Form: MCF112
 Revised July 2009

This form is available from the Arizona Department of Mines and Mineral Resources and may be reproduced.

MAINTENANCE FEE PAYMENT

Claimant Name: C. William & Marcelline J. Nichols
 Address: 26134 N. 93rd Ave.
 City: Peoria State: AZ Zip: 85383
 Telephone: 623-376-8045
 E-mail address: mjcwnichols@msio.com
 Signature: Marcelline J. Nichols

Check here if this is a change of address.

RECEIVED
 BLM AZ STATE OFFICE
 2012 AUG 29 P 1:26
 PHOENIX, ARIZONA

BLM
 Date
 Stamp

LINE NO.	AMC NUMBER	CLAIM/SITE NAME	COUNTY RECORDER DATA (if available)	TWP	RNG	SEC
40 1	384793	Estrella #1	2007-082-1529	15	2W	31
40 2	384794	Estrella #2	2007-082-1530	15	2W	31
40 3	384795	Estrella #3	2007-082-1531	15	2W	31
40 4	384796	Estrella #4	2007-082-1532	15	2W	31
5						
6						
7						
8						
9						
10						

List additional claims on Form MCF114.

Bureau of Land Management
 Arizona State Office
 www.blm.gov/az/

No. of Claims: 4 x \$140 = 560
 Check No: 23917 Unit: SC
 Receipt No.: 2644202
 For BLM Use Only

Form: MCF112
 Revised July 2009

MAINTENANCE FEE PAYMENT

Claimant Name: C William & Marianne J. Nichols
 Address: 26134 N. 93rd Ave.
 City: Peoria State: AZ Zip: 85383
 Telephone: 623-376-8045
 E-mail address: mjcnichols@msn.com
 Signature: Marianne J. Nichols

Check here if this is a change of address.

BLM
Date
Stamp

2012 AUG 29 P 1:27

PHOENIX, ARIZONA

RECEIVED
BLM AZ STATE OFFICE

LINE NO.	AMC NUMBER	CLAIM/SITE NAME	COUNTY RECORDER DATA (if available)	TWP	RNG	SEC
40 1	410303	Cordes Peak #1	2011-0047666	11N	2E	27
40 2	410304	Cordes Peak #2	2011-0047665	11N	2E	27
40 3	410302	Cordes Mountain #1	2011-0047667	11N	2E	27
4						
5						
6						
7						
8						
9						
10						

List additional claims on Form MCF114.

Bureau of Land Management
 Arizona State Office
 www.blm.gov/az/

No. of Claims: 3 x \$140 = 420
 Check No: 23917 Init. SC
 Receipt No.: 2644902
 For BLM Use Only

Form: MCF112
 Revised July 2009

This form is available from the Arizona Department of Mines and Mineral Resources and may be reproduced.

United States Department of the Interior
 Bureau of Land Management
 LANDS/RECREATION & PLANNING
 ONE N CENTRAL AVE
 PHOENIX, AZ 85004 -2203
 Phone: 602-417-9200

Receipt

No:

2644202

Transaction #: 2724944	
Date of Transaction: 08/29/2012	
CUSTOMER:	
C WILLIAMS NICHOLS 26134 N 93RD AVE PEORIA, AZ 85383-1350 US	

LINE #	QTY	DESCRIPTION	REMARKS	UNIT PRICE	TOTAL
1	1.00	LOCATABLE MINERALS / MINING CLAIMS-NOT NEW-UNADJUD, ONE AUTH NO. ONLY / MINING CLAIM MONEY RECEIVED CASES: AMC410303/\$9800.00	MAINT (70) 2013	- n/a -	9800.00
TOTAL:					\$9,800.00

PAYMENT INFORMATION					
1	AMOUNT:	9800.00	POSTMARKED:	N/A	
	TYPE:	CHECK	RECEIVED:	08/29/2012	
	CHECK NO:	23917			
	NAME:	KILAUEA CRUSHERS INC P O BOX 1606 GLENDALE AZ 85318 US			

REMARKS

This receipt was generated by the automated BLM Collections and Billing System and is a paper representation of a portion of the official electronic record contained therein.



United States Department of the Interior



BUREAU OF LAND MANAGEMENT

Arizona State Office

One North Central Avenue, Suite 800

Phoenix, Arizona 85004-4427

www.blm.gov/az/

November 2, 2012

In Reply Refer To:

3800 (9310) AT

AMC384793, AMC394051, AMC394491, AMC403058, AMC410302

NO. OF CLAIMS

AMOUNT \$ 2700.00

RECEIPT NO. 2696827

INIT. D.H.

** BLM-ASO**

CERTIFIED MAIL – RETURN RECEIPT REQUEST 7012 2210 0000 8675 2308

NOTICE

NICHOLS CHARLES WILLIAM, MARCILLINE

26134 N 93RD AVE

PEORIA, AZ 85383

This Notice Affects Those Claims

Shown in the Block Below.

AMC384793 - 384808, 394051, 394491 - 394513, 396284, 396285, 397074 - 397076, 398944 - 398947, 403058 - 403061, 410303, 410304

ESTRELLA 1 - 4; GILA MOUNTAIN 6 - 50, 1 - 4; CORDES PEAK #1, #2

2013 Maintenance Fees - Additional Fees Required

Your maintenance fee payment for the 2013 assessment year, in the amount of \$140 per claim, for the placer claims listed above, has been received and is insufficient. **The total due on your claim(s) is: \$87,700.**

In accordance with the Consolidated Appropriations Act of 2012, Public Law 112-74 (125 Stat 1047), and FR44155-44158 (2012) Congress changed the way maintenance fees for placer mining claims are assessed. Instead of charging the maintenance fee on a per-claim basis, Congress stated that the fee, which is currently \$140, will be assessed on each 20 acre parcel of a placer claim or portion thereof.

Insufficient payment of the annual maintenance fee for the 2013 assessment year is a curable defect. **Therefore you are required to do one of the following within 30 days of receipt of this notice or your claim(s) will be declared forfeited:** 1) submit additional fees of \$140 per 20-acres or portion thereof based on the full acreage of the claim, or 2) amend the claim(s) to reduce the acres so a lesser fee is due and submit any additional fees due; or 3) relinquish the claim(s) in their entirety, in which case BLM will refund the maintenance fees you have already paid for the 2013 assessment year.

If you choose to amend the claims to reduce the acres, you must submit an amended location notice for each claim, with an accurate description and dimensions of the reduced claim, along with a map depicting the reduced claim, and a \$10 processing fee per amendment. An amendment must also be recorded at the county. If the amended claim contains more than 20 acres, calculate the additional fees due and submit those fees with the amendment(s).

ENCLOSURE

11/21/12 AT

1:56

Please include your Arizona Mining Claim (AMC) serial number(s) and claim name(s) when submitting the additional fees, and note that you are paying additional fees due. If additional information is required, please contact Amy Thrower at 602-417-9334.

Rebecca Heick

Rebecca Heick
Group Administrator
Lands and Minerals

RECEIVED
2012 NOV 15 P 1:56
PHOENIX, ARIZONA



C. William & Marcilline Nichols
26134 N. 93rd Ave.
Peoria, AZ 85383-1350

CERTIFIED MAIL™

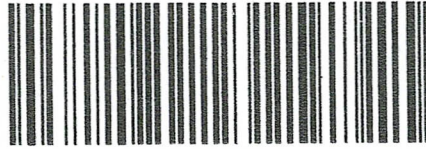

7008 1830 0001 6700 5741



1000

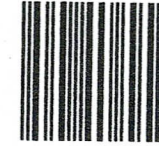

85004

U.S. POSTAGE
PAID
GLENDALE, AZ
85308
NOV 14, 12
AMOUNT

\$5.75
00088291-06

RECEIVED
BLM AZ STATE OFFICE

2012 NOV 15 P 1:51

PHOENIX, ARIZONA

*Bureau of Land Management
Arizona State office
1 North Central Ave, Suite 800
Phoenix AZ 85004*

8500434427



**RETURN RECEIPT
REQUESTED**

United States Department of the Interior
Bureau of Land Management
 LANDS/RECREATION & PLANNING
 ONE N CENTRAL AVE
 PHOENIX, AZ 85004 -2203
 Phone: 602-417-9200

Receipt

No: 2690827

Transaction #: 2772484	
Date of Transaction: 11/16/2012	
CUSTOMER:	
CHARLES WILLIAM NICHOLS 26134 N 93RD AVE PEORIA, AZ 85383-1350 US	

LINE #	QTY	DESCRIPTION	REMARKS	UNIT PRICE	TOTAL
1	1.00	LOCATABLE MINERALS / MINING CLAIMS-NOT NEW-UNADJUD, ONE AUTH NO. ONLY / MINING CLAIM MONEY RECEIVED CASES: AMC384793/\$7700.00	ADDITIONAL MONIES FOR MAINT FEE PYMNT 2013	- n/a -	7700.00
TOTAL:					\$7,700.00

PAYMENT INFORMATION			
1	AMOUNT:	7700.00	POSTMARKED: 11/14/2012
	TYPE:	CHECK	RECEIVED: 11/16/2012
	CHECK NO:	134	
	NAME:	NICHOLS, MARCILLINE J 26134 N 93RD AVE PEORIA AZ 85383-1350 US	

REMARKS

This receipt was generated by the automated BLM Collections and Billing System and is a paper representation of a portion of the official electronic record contained therein.

AMC 398944
 398962
 384793
 394491
 394513
 394051
 396284
 396392

MAINTENANCE FEE PAYMENT

Claimant Name: C William Nichols + Marcelline J. Nichols
 Address: 26134 N. 93rd Ave.
 City: Peoria State: Az Zip: 85383
 Telephone: 623-376-8045
 E-mail address: mjnw@nichols@msn.com
 Signature: Marcelline J. Nichols

RECEIVED
 PLM AZ STATE OFFICE
 200 AUG 23 P 1:41
 PHOENIX, ARIZONA
 BLM
 Date
 Stamp

Check here if this is a change of address.

LINE NO.	AMC NUMBER	CLAIM/SITE NAME	COUNTY RECORDER DATA (If available)	TWP	RNG	SEC
1	398948	Sunset #1	2009-1150822	15	4W	25
2	398949	Sunset #2	2009-1150823	15	4W	25
3	398950	Sunset #3	2009-1150824	15	4W	25
4	398962	Sunset #4	2009-1150825	15	4W	25
5	398963	Sunset #5	2009-1150826	15	4W	25
6	398964	Sunset #6	2009-1150827	15	4W	25
7	398951	Sunset #7	2009-1150828	25	4W	1
8	398952	Sunset #8	2009-1150829	25	4W	1
9	398953	Sunset #9	2009-1150830	25	4W	1
10	398954	Sunset #10	2009-1150831	25	4W	1

List additional claims on Form MCF114.

Bureau of Land Management
 Arizona State Office
 www.blm.gov/az

No. of Claims: 11 x \$140 = 1540.
 Check No: 20203 Init. SC
 Receipt No.: 2197530
 For BLM Use Only

Form: MCF112
 Revised July 2009

This form is available from the Arizona Department of Mines and Mineral Resources and may be reproduced.

10/50

SUPPLEMENTAL ATTACHMENT

May be used with the following forms for listing additional mining claims:

Check One.

- Affidavit of Performance of Annual Work
- Maintenance Fee Payment
- Notice of Intent to Hold Mining Claims
- Notice of Non-Liability for Labor and Materials Furnished

RECEIVED
BLM AZ STATE OFFICE
2010 AUG 23 P 1:44
PHOENIX, ARIZONA

BLM
Date
Stamp

LINE NO.	AMC NUMBER	CLAIM/SITE NAME	COUNTY RECORDER DATA (If available)	TWP	RNG	SEC
11	398955	Sunset # 11	2009-1150832	25	4W	1

Form MCF114
Revised June 2005

This form is available from the Arizona Department of Mines & Mineral Resources and may be reproduced.

1/90

417C 398944
 398962
 384793
 394491
 394513
 394051
 346284
 396392

MAINTENANCE FEE PAYMENT

Claimant Name: C William Nichols + Marcelline J Nichols
 Address: 26134 N. 93rd Ave.
 City: Peoria State: AZ Zip: 85383
 Telephone: 623-376-8045
 E-mail address: myaw.nichols@msn.com
 Signature: Marcelline J Nichols

RECEIVED
 PLM AZ STATE OFFICE
 2010 AUG 23 P 1:41
 PHOENIX, ARIZONA
 BLM
 Date
 Stamp

Check here if this is a change of address.

LINE NO.	AMC NUMBER	CLAIM/SITE NAME	COUNTY RECORDER DATA (If available)	TWP	RNG	SEC
1	398948	Sunset #1	2009-1150822	15	4W	25
2	398949	Sunset #2	2009-1150823	15	4W	25
3	398950	Sunset #3	2009-1150824	15	4W	25
4	398962	Sunset #4	2009-1150825	15	4W	25
5	398963	Sunset #5	2009-1150826	15	4W	25
6	398964	Sunset #6	2009-1150827	15	4W	25
7	398951	Sunset #7	2009-1150828	25	4W	1
8	398952	Sunset #8	2009-1150829	25	4W	1
9	398953	Sunset #9	2009-1150830	25	4W	1
10	398954	Sunset #10	2009-1150831	25	4W	1

List additional claims on Form MCF114.

Bureau of Land Management
 Arizona State Office

No. of Claims: 11 x \$140 = 1540.
 Check No: 20203 Init. SC
 Receipt No.: 2197530
 For BLM Use Only

Form: MCF112
 Revised July 2009

This form is available from the Arizona Department of Mines and Mineral Resources and may be reproduced.

0/50

SUPPLEMENTAL ATTACHMENT

May be used with the following forms for listing additional mining claims:

Check One.

- Affidavit of Performance of Annual Work
- Maintenance Fee Payment
- Notice of Intent to Hold Mining Claims
- Notice of Non-Liability for Labor and Materials Furnished

RECEIVED
BLM STATE OFFICE
PHOENIX, ARIZONA
2008 AUG 23 P 1:41
BLM
Date
Stamp

LINE NO.	AMC NUMBER	CLAIM/SITE NAME	COUNTY RECORDER DATA (If available)	TWP	RNG	SEC
11	384807	Sila Mountain #16	2007-0821543	2S	4W	13
12	384808	Sila Mountain #17	2007-0821544	2S	4W	13
13	394491	Sila Mountain #18	2008-0734873	2S	4W	1
14	394492	Sila Mountain #19	2008-0734874	2S	4W	12
15	394493	Sila Mountain #20	2008-0734875	2S	4W	12
16	394494	Sila Mountain #21	2008-0734876	2S	4W	12
17	394495	Sila Mountain #22	2008-0734877	2S	4W	12
18	394496	Sila Mountain #23	2008-0734878	2S	4W	12
19	394497	Sila Mountain #24	2008-0734879	2S	4W	12
20	394498	Sila Mountain #25	2008-0734880	2S	4W	12
21	394499	Sila Mountain #26	2008-0734881	2S	4W	12
22	394500	Sila Mountain #27	2008-0734882	2S	4W	12
23	394501	Sila Mountain #28	2008-0734883	2S	4W	12
24	394502	Sila Mountain #29	2008-0734884	2S	4W	12
25	394503	Sila Mountain #30	2008-0734885	2S	4W	1
26	394504	Sila Mountain #31	2008-0734886	2S	4W	1
27	394505	Sila Mountain #32	2008-0734887	2S	4W	12
28	394506	Sila Mountain #33	2008-0734888	2S	4W	1
29	394507	Sila Mountain #34	2008-0734889	2S	4W	1

Form MCF114
Revised June 2005

This form is available from the Arizona Department of Mines & Mineral Resources and may be reproduced.

19/50

MAINTENANCE FEE PAYMENT

Claimant Name: C. William & Marcellene J Nichols
 Address: 26134 N. 93rd Ave.
 City: Peoria State: AZ Zip: 85383
 Telephone: 623-376-8045
 E-mail address: mjenichols@msn.com
 Signature: Marcellene Nichols

Check here if this is a change of address.

RECEIVED
 CLAIMS OFFICE
 TUCSON, ARIZONA
 2010 AUG 23 P 1:41
 BLM
 Date
 Stamp

LINE NO.	AMC NUMBER	CLAIM/SITE NAME	COUNTY RECORDER DATA (If available)	TWP	RNG	SEC
1	384797	Sila Mountain #6	2007-0821533	2S	4W	12
2	384798	Sila Mountain #7	2007-0821534	2S	4W	12
3	384799	Sila Mountain #8	2007-0821535	2S	4W	12
4	384800	Sila Mountain #9	2007-0821536	2S	4W	12
5	384801	Sila Mountain #10	2007-0821537	2S	4W	12
6	384802	Sila Mountain #11	2007-0821538	2S	4W	13
7	384803	Sila Mountain #12	2007-0821539	2S	4W	13
8	384804	Sila Mountain #13	2007-0821540	2S	4W	13
9	384805	Sila Mountain #14	2007-0821541	2S	4W	13
10	384806	Sila Mountain #15	2007-0821542	2S	4W	13

List additional claims on Form MCF114.

Bureau of Land Management
 Arizona State Office

No. of Claims: 45 x \$140 = 6300.
 Check No: 20203 Init. SC
 Receipt No.: 2197530
 For BLM Use Only

Form: MCF112
 Revised July 2009

This form is available from the Arizona Department of Mines and Mineral Resources and may be reproduced.

9/50

SUPPLEMENTAL ATTACHMENT

May be used with the following forms for listing additional mining claims:

Check One.

- Affidavit of Performance of Annual Work
- Maintenance Fee Payment
- Notice of Intent to Hold Mining Claims
- Notice of Non-Liability for Labor and Materials Furnished

RECEIVED
BLM AZ STATE OFFICE
PHOENIX, ARIZONA
2009 AUG 23 P 1:41
BLM
Date
Stamp

LINE NO.	AMC NUMBER	CLAIM/SITE NAME	COUNTY RECORDER DATA (If available)	TWP	RNG	SEC
30	394508	Sila Mountain #35	2008-0734890	2S	4W	1
31	394509	Sila Mountain #36	2008-0734891	2S	4W	1
32	394910	Sila Mountain #37	2008-0734892	2S	4W	1
33	394511	Sila Mountain #38	2008-0734893	2S	4W	1
34	394512	Sila Mountain #39	2008-0734894	2S	4W	13
35	394051	Sila Mountain #40	2008-0736826	2S	3W	7
36	394513	Sila Mountain #41	2008-0737568	2S	4W	1
37	396284	Sila Mountain #42	2009-0214882	2S	3W	6
38	396285	Sila Mountain #43	2009-0214883	2S	3W	6
39	397074	Sila Mountain #44	2009-0635328	2S	3W	6
40	397075	Sila Mountain #45	2009-0635329	2S	3W	6
41	397076	Sila Mountain #46	2009-0635330	2S	3W	7
42	398944	Sila Mountain #47	2009-1150818	1S	4W	25
43	398945	Sila Mountain #48	2009-1150819	1S	4W	25
44	398946	Sila Mountain #49	2009-1150820	1S	4W	25
45	398947	Sila Mountain #50	2009-1150821	1S	4W	25

Form MCF114
Revised June 2005

This form is available from the Arizona Department of Mines & Mineral Resources and may be reproduced.

16/50

MAINTENANCE FEE PAYMENT

Claimant Name: C. William & Marcelline J. Nichols
 Address: 26134 N. 93rd Ave.
 City: Peoria State: AZ Zip: 85383
 Telephone: 623-376-8045
 E-mail address: mjewnichols@msn.com
 Signature: Marcelline J. Nichols

Check here if this is a change of address.

RECEIVED
 PLM AZ STATE OFFICE
 2010 AUG 23 P 1:41
 PHOENIX, ARIZONA
 BLM
 Date
 Stamp

LINE NO.	AMC NUMBER	CLAIM/SITE NAME	COUNTY RECORDER DATA (If available)	TWP	RNG	SEC
1	396392	Gila Mountain ^{Locke} #1	2009-0295666	25	3W	6
2						
3						
4						
5						
6						
7						
8						
9						
10						

List additional claims on Form MCF114.

Bureau of Land Management
 Arizona State Office
 www.blm.gov/az

No. of Claims: 1 x \$140 = 140
 Check No: 20203 Init. SC
 Receipt No.: 2197530
 For BLM Use Only

Form: MCF112
 Revised July 2009

This form is available from the Arizona Department of Mines and Mineral Resources and may be reproduced.

1/50

MAINTENANCE FEE PAYMENT

Claimant Name: C. William & Marcelline J. Nichols
 Address: 26134 N. 93rd Ave.
 City: Peoria State: AZ Zip: 85383
 Telephone: 623-376-8045
 E-mail address: _____
 Signature: _____

Check here if this is a change of address.

RECEIVED
 BLM AZ STATE OFFICE
 2010 AUG 23 P 1:41
 PHOENIX, ARIZONA
 BLM
 Date
 Stamp

LINE NO.	AMC NUMBER	CLAIM/SITE NAME	COUNTY RECORDER DATA (If available)	TWP	RNG	SEC
1	384793	Estrella #1	2007-0821529	1S	2W	31
2	384794	Estrella #2	2007-0821530	1S	2W	31
3	384795	Estrella #3	2007-0821531	1S	2W	31
4	384796	Estrella #4	2007-0821532	1S	2W	31
5						
6						
7						
8						
9						
10						

ENTERED INTO COMPUTER
 SEP 02 2010
 SEP 02 2010

List additional claims on Form MCF114.

Bureau of Land Management
 Arizona State Office
 www.blm.gov

No. of Claims: 4 x \$140 = \$560.
 Check No: 20203 Init. SC
 Receipt No.: 2197530
 For BLM Use Only

Form: MCF112
 Revised July 2009

This form is available from the Arizona Department of Mines and Mineral Resources and may be reproduced.

f/sc

United States Department of the Interior
 Bureau of Land Management
 LANDS/RECREATION & PLANNING
 ONE N CENTRAL AVE
 PHOENIX, AZ 85004 -2203
 Phone:

Receipt

No: 2197530

Transaction #: 2267406		ENTERED INTO COMPUTER
Date of Transaction: 08/23/2010		
CUSTOMER:	CWILLIAMS NICHOLS 26134 N 93RD AVE PEORIA, AZ 85383-1350 US	SEP 02 2010

LINE #	QTY	DESCRIPTION	REMARKS	UNIT PRICE	TOTAL
1	1.00	LOCATABLE MINERALS / MINING CLAIMS-NOT NEW-UNADJUD, ONE AUTH NO. ONLY / MINING CLAIM MONEY RECEIVED CASES: AMC396392/\$8540.00	MAINT (61) 2011	- n/a -	8540.00
TOTAL:					\$8,540.00

PAYMENT INFORMATION			
1	AMOUNT:	8540.00	POSTMARKED: N/A
	TYPE:	CHECK	RECEIVED: 08/23/2010
	CHECK NO:	20203	
	NAME:	NICHOLS, CWILLIAMS 26134 N 93RD AVE PEORIA AZ 85383-1350 US	

REMARKS

This receipt was generated by the automated BLM Collections and Billing System and is a paper representation of a portion of the official electronic record contained therein.

DEPARTMENT OF THE INTERIOR
BUREAU OF LAND MANAGEMENT
MINING CLAIMS
MC Customer Information - With OUT Legal Description
ACTIVE, CLOSED CLAIMS

Run Date: 09/02/2010 09:41 AM

Page 7 of 7

<u>Serial No</u>	<u>Claim Name/Number</u>	<u>County</u>	<u>Disposition</u>	<u>Int Rel</u>
AMC394507	GILA MOUNTAIN #34	MARICOPA	ACTIVE	CLAIMANT
AMC394508	GILA MOUNTAIN #35	MARICOPA	ACTIVE	CLAIMANT
AMC394509	GILA MOUNTAIN #36	MARICOPA	ACTIVE	CLAIMANT
AMC394510	GILA MOUNTAIN #37	MARICOPA	ACTIVE	CLAIMANT
AMC394511	GILA MOUNTAIN #38	MARICOPA	ACTIVE	CLAIMANT
AMC394512	GILA MOUNTAIN #39	MARICOPA	ACTIVE	CLAIMANT
AMC394513	GILA MOUNTAIN #41	MARICOPA	ACTIVE	CLAIMANT
AMC396284	GILA MOUNTAIN #42	MARICOPA	ACTIVE	CLAIMANT
AMC396285	GILA MOUNTAIN #43	MARICOPA	ACTIVE	CLAIMANT
AMC396392	GILA MOUNTAIN LODE 1	MARICOPA	ACTIVE	CLAIMANT
AMC397074	GILA MOUNTAIN #44	MARICOPA	ACTIVE	CLAIMANT
AMC397075	GILA MOUNTAIN #45	MARICOPA	ACTIVE	CLAIMANT
AMC397076	GILA MOUNTAIN #46	MARICOPA	ACTIVE	CLAIMANT
AMC398944	GILA MOUNTAIN #47	MARICOPA	ACTIVE	CLAIMANT
AMC398945	GILA MOUNTAIN #48	MARICOPA	ACTIVE	CLAIMANT
AMC398946	GILA MOUNTAIN #49	MARICOPA	ACTIVE	CLAIMANT
AMC398947	GILA MOUNTAIN #50	MARICOPA	ACTIVE	CLAIMANT
AMC398948	SUNSET #1	MARICOPA	ACTIVE	CLAIMANT
AMC398949	SUNSET #2	MARICOPA	ACTIVE	CLAIMANT
AMC398950	SUNSET #3	MARICOPA	ACTIVE	CLAIMANT
AMC398951	SUNSET #7	MARICOPA	ACTIVE	CLAIMANT
AMC398952	SUNSET #8	MARICOPA	ACTIVE	CLAIMANT
AMC398953	SUNSET #9	MARICOPA	ACTIVE	CLAIMANT
AMC398954	SUNSET #10	MARICOPA	ACTIVE	CLAIMANT
AMC398955	SUNSET #11	MARICOPA	ACTIVE	CLAIMANT
AMC398962	SUNSET #4	MARICOPA	ACTIVE	CLAIMANT
AMC398963	SUNSET #5	MARICOPA	ACTIVE	CLAIMANT
AMC398964	SUNSET #6	MARICOPA	ACTIVE	CLAIMANT

NO WARRANTY IS MADE BY BLM FOR USE OF THE DATA
FOR PURPOSES NOT INTENDED BY BLM.

AMC 398944

398962

384793

394491

394513

394051

396284

396392

MAINTENANCE FEE PAYMENT

Claimant Name: C William Nichols + Marcelline J Nichols

Address: 26134 N. 93rd Ave.

City: Peoria State: Az Zip: 85383

Telephone: 623-376-8045

E-mail address: mjnw.nichols@msn.com

Signature: Marcelline Nichols

Check here if this is a change of address.

RECEIVED
 DLM AZ STATE OFFICE
 200 AUG 23 P 1:41
 PHOENIX, ARIZONA
 BLM
 Date
 Stamp

LINE NO.	AMC NUMBER	CLAIM/SITE NAME	COUNTY RECORDER DATA (If available)	TWP	RNG	SEC
1	398948	Sunset #1	2009-1150822	15	4W	25
2	398949	Sunset #2	2009-1150823	15	4W	25
3	398950	Sunset #3	2009-1150824	15	4W	25
4	398962	Sunset #4	2009-1150825	15	4W	25
5	398963	Sunset #5	2009-1150826	15	4W	25
6	398964	Sunset #6	2009-1150827	15	4W	25
7	398951	Sunset #7	2009-1150828	25	4W	1
8	398952	Sunset #8	2009-1150829	25	4W	1
9	398953	Sunset #9	2009-1150830	25	4W	1
10	398954	Sunset #10	2009-1150831	25	4W	1

List additional claims on Form MCF114.

Bureau of Land Management
Arizona State Office

www.blm.gov/az/

No. of Claims: 11 x \$140 = 1540.
 Check No: 20203 Init. SC
 Receipt No.: 2197530
 For BLM Use Only

Form: MCF112
Revised July 2009

This form is available from the Arizona Department of Mines and Mineral Resources and may be reproduced.

10/5c

SUPPLEMENTAL ATTACHMENT

May be used with the following forms for listing additional mining claims:

Check One.

- Affidavit of Performance of Annual Work
- Maintenance Fee Payment
- Notice of Intent to Hold Mining Claims
- Notice of Non-Liability for Labor and Materials Furnished

BLM
Date
Stamp

RECEIVED
BLM AZ STATE OFFICE
PHOENIX, ARIZONA
2010 AUG 23 P 1:41

LINE NO.	AMC NUMBER	CLAIM/SITE NAME	COUNTY RECORDER DATA (if available)	TWP	RNG	SEC
11	398955	Sunset #11	2009-1150832	25	4W	1

Form MCF114
Revised June 2005

This form is available from the Arizona Department of Mines & Mineral Resources and may be reproduced.

1/50

917C 398944
 398962
 384793
 394491
 394513
 394051
 396284
 396392

MAINTENANCE FEE PAYMENT

Claimant Name: C William Nichols + Marcelline J Nichols
 Address: 26134 N. 93rd Ave.
 City: Peoria State Az Zip: 85383
 Telephone: 623-376-8045
 E-mail address: mjw@nichols@msn.com
 Signature: Marcelline J Nichols
 Check here if this is a change of address.

RECEIVED
 PLMAZ STATE OFFICE
 2010 AUG 23 P 1:41
 PHOENIX, ARIZONA
 BLM
 Date
 Stamp

LINE NO.	AMC NUMBER	CLAIM/SITE NAME	COUNTY RECORDER DATA (If available)	TWP	RNG	SEC
1	398948	Sunset #1	2009-1150822	1S	4W	25
2	398949	Sunset #2	2009-1150823	1S	4W	25
3	398950	Sunset #3	2009-1150824	1S	4W	25
4	398962	Sunset #4	2009-1150825	1S	4W	25
5	398963	Sunset #5	2009-1150826	1S	4W	25
6	398964	Sunset #6	2009-1150827	1S	4W	25
7	398951	Sunset #7	2009-1150828	2S	4W	1
8	398952	Sunset #8	2009-1150829	2S	4W	1
9	398953	Sunset #9	2009-1150830	2S	4W	1
10	398954	Sunset #10	2009-1150831	2S	4W	1

List additional claims on Form MCF114.

Bureau of Land Management
 Arizona State Office

No. of Claims: 11 x \$140 = 1540.
 Check No: 20203 Init. SC
 Receipt No.: 2197530
 For BLM Use Only

Form: MCF112
 Revised July 2009

This form is available from the Arizona Department of Mines and Mineral Resources and may be reproduced.

0/5c

SUPPLEMENTAL ATTACHMENT

May be used with the following forms for listing additional mining claims:

Check One.

- Affidavit of Performance of Annual Work
- Maintenance Fee Payment
- Notice of Intent to Hold Mining Claims
- Notice of Non-Liability for Labor and Materials Furnished

RECEIVED
CLIMATE-RELATED-FILES
2010 AUG 23 P 1:44
PHOENIX, ARIZONA

BLM
Date
Stamp

LINE NO.	AMC NUMBER	CLAIM/SITE NAME	COUNTY RECORDER DATA (if available)	TWP	RNG	SEC
11	384807	Sila Mountain #16	2007-0821543	2S	4W	13
12	384808	Sila Mountain #17	2007-0821544	2S	4W	13
13	394491	Sila Mountain #18	2008-0734873	2S	4W	1
14	394492	Sila Mountain #19	2008-0734874	2S	4W	12
15	394493	Sila Mountain #20	2008-0734875	2S	4W	12
16	394494	Sila Mountain #21	2008-0734876	2S	4W	12
17	394495	Sila Mountain #22	2008-0734877	2S	4W	12
18	394496	Sila Mountain #23	2008-0734878	2S	4W	12
19	394497	Sila Mountain #24	2008-0734879	2S	4W	12
20	394498	Sila Mountain #25	2008-0734880	2S	4W	12
21	394499	Sila Mountain #26	2008-0734881	2S	4W	12
22	394500	Sila Mountain #27	2008-0734882	2S	4W	12
23	394501	Sila Mountain #28	2008-0734883	2S	4W	12
24	394502	Sila Mountain #29	2008-0734884	2S	4W	12
25	394503	Sila Mountain #30	2008-0734885	2S	4W	1
26	394504	Sila Mountain #31	2008-0734886	2S	4W	1
27	394505	Sila Mountain #32	2008-0734887	2S	4W	12
28	394506	Sila Mountain #33	2008-0734888	2S	4W	1
29	394507	Sila Mountain #34	2008-0734889	2S	4W	1

Form MCF114
Revised June 2005

This form is available from the Arizona Department of Mines & Mineral Resources and may be reproduced.

19/50

MAINTENANCE FEE PAYMENT

Claimant Name: C. William & Marcelline J Nichols
 Address: 26134 N. 93rd Ave.
 City: Peoria State: AZ Zip: 85383
 Telephone: 623-376-8045
 E-mail address: mjcnichols@msn.com
 Signature: Marcelline J Nichols

Check here if this is a change of address.

RECEIVED
 CLAIMS OFFICE
 PHOENIX, ARIZONA
 2010 AUG 23 P 1:41

BLM
 Date
 Stamp

LINE NO.	AMC NUMBER	CLAIM/SITE NAME	COUNTY RECORDER DATA (If available)	TWP	RNG	SEC
1	384797	Sila Mountain #6	2007-0821533	2S	4W	12
2	384798	Sila Mountain #7	2007-0821534	2S	4W	12
3	384799	Sila Mountain #8	2007-0821535	2S	4W	12
4	384800	Sila Mountain #9	2007-0821536	2S	4W	12
5	384801	Sila Mountain #10	2007-0821537	2S	4W	12
6	384802	Sila Mountain #11	2007-0821538	2S	4W	13
7	384803	Sila Mountain #12	2007-0821539	2S	4W	13
8	384804	Sila Mountain #13	2007-0821540	2S	4W	13
9	384805	Sila Mountain #14	2007-0821541	2S	4W	13
10	384806	Sila Mountain #15	2007-0821542	2S	4W	13

List additional claims on Form MCF114.

Bureau of Land Management
 Arizona State Office

No. of Claims: 45 x \$140 = 6300.
 Check No: 20203 Init. SC
 Receipt No.: 2197530
 For BLM Use Only

Form: MCF112
 Revised July 2009

This form is available from the Arizona Department of Mines and Mineral Resources and may be reproduced.

10/50

SUPPLEMENTAL ATTACHMENT

May be used with the following forms for listing additional mining claims:

Check One.

- Affidavit of Performance of Annual Work
- Maintenance Fee Payment
- Notice of Intent to Hold Mining Claims
- Notice of Non-Liability for Labor and Materials Furnished

RECEIVED
 PHOENIX, ARIZONA
 2009 AUG 23 P 1:41
 BLM
 Date
 Stamp

LINE NO.	AMC NUMBER	CLAIM/SITE NAME	COUNTY RECORDER DATA (If available)	TWP	RNG	SEC
30	394508	Hila Mountain #35	2008-0734890	2S	4W	1
31	394509	Hila Mountain #36	2008-0734891	2S	4W	1
32	394910	Hila Mountain #37	2008-0734892	2S	4W	1
33	394511	Hila Mountain #38	2008-0734893	2S	4W	1
34	394512	Hila Mountain #39	2008-0734894	2S	4W	13
35	394051	Hila Mountain #40	2008-0736826	2S	3W	7
36	394513	Hila Mountain #41	2008-0737568	2S	4W	1
37	396284	Hila Mountain #42	2009-0214882	2S	3W	6
38	396285	Hila Mountain #43	2009-0214883	2S	3W	6
39	397074	Hila Mountain #44	2009-0635328	2S	3W	6
40	397075	Hila Mountain #45	2009-0635329	2S	3W	6
41	397076	Hila Mountain #46	2009-0635330	2S	3W	7
42	398944	Hila Mountain #47	2009-1150818	1S	4W	25
43	398945	Hila Mountain #48	2009-1150819	1S	4W	25
44	398946	Hila Mountain #49	2009-1150820	1S	4W	25
45	398947	Hila Mountain #50	2009-1150821	1S	4W	25

Form MCF114
 Revised June 2005

This form is available from the Arizona Department of Mines & Mineral Resources and may be reproduced.

16/50

MAINTENANCE FEE PAYMENT

Claimant Name: C. William + Marcelline J. Nichols

Address: 26134 N. 93rd Ave.

City: Peoria State: AZ Zip: 85383

Telephone: 623-376-8045

E-mail address: mjcwNichols@msn.com

Signature: Marcelline Nichols

Check here if this is a change of address.

RECEIVED
 PLM AZ STATE OFFICE
 2010 AUG 23 P 1:41
 PHOENIX, ARIZONA
 BLM
 Date
 Stamp

LINE NO.	AMC NUMBER	CLAIM/SITE NAME	COUNTY RECORDER DATA (If available)	TWP	RNG	SEC
1	396392	Gila Mountain ^{Loc 1} #1	2009-0295666	25	3W	6
2						
3						
4						
5						
6						
7						
8						
9						
10						

List additional claims on Form MCF114.

Bureau of Land Management
 Arizona State Office

No. of Claims: 1 x \$140 = 140
 Check No: 20203 Init. SC
 Receipt No.: 2197530
 For BLM Use Only

Form: MCF112
 Revised July 2009

This form is available from the Arizona Department of Mines and Mineral Resources and may be reproduced.

1/50

MAINTENANCE FEE PAYMENT

Claimant Name: C. William & Marcelline J. Nichols

Address: 26134 N. 93rd Ave.

City: Peoria State: AZ Zip: 85383

Telephone: 623-376-8045

E-mail address: _____

Signature: _____

Check here if this is a change of address.

RECEIVED
 PHOENIX, ARIZONA
 2010 AUG 23 P 1:41
 BLM
 Date
 Stamp

LINE NO.	AMC NUMBER	CLAIM/SITE NAME	COUNTY RECORDER DATA (If available)	TWP	RNG	SEC
1	384793	Estrella #1	2007-0821529	15	2W	31
2	384794	Estrella #2	2007-0821530	15	2W	31
3	384795	Estrella #3	2007-0821531	15	2W	31
4	384796	Estrella #4	2007-0821532	15	2W	31
5						
6						
7						
8						
9						
10						

ENTERED INTO COMPUTER
 SEP 02 2010
 SEP 02 2010

List additional claims on Form MCF114.

**Bureau of Land Management
Arizona State Office**

No. of Claims: 4 x \$140 = 560.
 Check No: 20203 Init. SC
 Receipt No.: 2197530
 For BLM Use Only

Form: MCF112
Revised July 2009

This form is available from the Arizona Department of Mines and Mineral Resources and may be reproduced.

150

United States Department of the Interior
 Bureau of Land Management
 LANDS/RECREATION & PLANNING
 ONE N CENTRAL AVE
 PHOENIX, AZ 85004 -2203
 Phone:

Receipt

No: 2197530

Transaction #: 2267406		ENTERED INTO COMPUTER
Date of Transaction: 08/23/2010		
CUSTOMER:	CWILLIAMS NICHOLS 26134 N 93RD AVE PEORIA, AZ 85383-1350 US	SEP 02 2010

LINE #	QTY	DESCRIPTION	REMARKS	UNIT PRICE	TOTAL
1	1.00	LOCATABLE MINERALS / MINING CLAIMS-NOT NEW-UNADJUD, ONE AUTH NO. ONLY / MINING CLAIM MONEY RECEIVED CASES: AMC396392/\$8540.00	MAINT (61) 2011	- n/a -	8540.00
TOTAL:					\$8,540.00

PAYMENT INFORMATION			
1	AMOUNT:	8540.00	POSTMARKED: N/A
	TYPE:	CHECK	RECEIVED: 08/23/2010
	CHECK NO:	20203	
	NAME:	NICHOLS, CWILLIAMS 26134 N 93RD AVE PEORIA AZ 85383-1350 US	

REMARKS

This receipt was generated by the automated BLM Collections and Billing System and is a paper representation of a portion of the official electronic record contained therein.

DEPARTMENT OF THE INTERIOR
BUREAU OF LAND MANAGEMENT
MINING CLAIMS
MC Customer Information - With OUT Legal Description
ACTIVE, CLOSED CLAIMS

Run Date: 09/02/2010 09:41 AM

Page 7 of 7

<u>Serial No</u>	<u>Claim Name/Number</u>	<u>COUNTY</u>	<u>Disposition</u>	<u>Int. Rel</u>
AMC394507	GILA MOUNTAIN #34	MARICOPA	ACTIVE	CLAIMANT
AMC394508	GILA MOUNTAIN #35	MARICOPA	ACTIVE	CLAIMANT
AMC394509	GILA MOUNTAIN #36	MARICOPA	ACTIVE	CLAIMANT
AMC394510	GILA MOUNTAIN #37	MARICOPA	ACTIVE	CLAIMANT
AMC394511	GILA MOUNTAIN #38	MARICOPA	ACTIVE	CLAIMANT
AMC394512	GILA MOUNTAIN #39	MARICOPA	ACTIVE	CLAIMANT
AMC394513	GILA MOUNTAIN #41	MARICOPA	ACTIVE	CLAIMANT
AMC396284	GILA MOUNTAIN #42	MARICOPA	ACTIVE	CLAIMANT
AMC396285	GILA MOUNTAIN #43	MARICOPA	ACTIVE	CLAIMANT
AMC396392	GILA MOUNTAIN LODGE 1	MARICOPA	ACTIVE	CLAIMANT
AMC397074	GILA MOUNTAIN #44	MARICOPA	ACTIVE	CLAIMANT
AMC397075	GILA MOUNTAIN #45	MARICOPA	ACTIVE	CLAIMANT
AMC397076	GILA MOUNTAIN #46	MARICOPA	ACTIVE	CLAIMANT
AMC398944	GILA MOUNTAIN #47	MARICOPA	ACTIVE	CLAIMANT
AMC398945	GILA MOUNTAIN #48	MARICOPA	ACTIVE	CLAIMANT
AMC398946	GILA MOUNTAIN #49	MARICOPA	ACTIVE	CLAIMANT
AMC398947	GILA MOUNTAIN #50	MARICOPA	ACTIVE	CLAIMANT
AMC398948	SUNSET #1	MARICOPA	ACTIVE	CLAIMANT
AMC398949	SUNSET #2	MARICOPA	ACTIVE	CLAIMANT
AMC398950	SUNSET #3	MARICOPA	ACTIVE	CLAIMANT
AMC398951	SUNSET #7	MARICOPA	ACTIVE	CLAIMANT
AMC398952	SUNSET #8	MARICOPA	ACTIVE	CLAIMANT
AMC398953	SUNSET #9	MARICOPA	ACTIVE	CLAIMANT
AMC398954	SUNSET #10	MARICOPA	ACTIVE	CLAIMANT
AMC398955	SUNSET #11	MARICOPA	ACTIVE	CLAIMANT
AMC398962	SUNSET #4	MARICOPA	ACTIVE	CLAIMANT
AMC398963	SUNSET #5	MARICOPA	ACTIVE	CLAIMANT
AMC398964	SUNSET #6	MARICOPA	ACTIVE	CLAIMANT

NO WARRANTY IS MADE BY BLM FOR USE OF THE DATA
FOR PURPOSES NOT INTENDED BY BLM.

AMC 396392
 384793
 394491
 394051
 394513
 396284
 39707

MAINTENANCE FEE PAYMENT

Claimant Name: C. William & Marjorie J. Nichols

Address: 26134 N. 93rd Ave.

City: Piccola State: AZ Zip: 85383

Telephone: 623-376-8045

E-mail address: mjewnichols@msn.com

Signature: Marjorie Nichols

Check here if this is a change of address.

RECEIVED
 LAND STATE OFFICE
 2009 AUG 31 P 12:53
 PHOENIX, ARIZONA
 BLM
 Date
 Stamp

LINE NO.	AMC NUMBER	CLAIM/SITE NAME	COUNTY RECORDER DATA (If available)	TWP	RNG	SEC
1	396392	Mela Mountain ^{Lode} #1	2009-0295666	2S	3W	6
2						
3						
4						
5						
6						
7						
8						
9						
10						

List additional claims on Form MCF114.

Bureau of Land Management
 Arizona State Office
 www.blm.gov/az/

No. of Claims: 1 x \$140 = 14000
 Check No: 18467 Init. SC
 Receipt No.: 1992278
 For BLM Use Only

Form: MCF112
 Revised July 2009

This form is available from the Arizona Department of Mines and Mineral Resources and may be reproduced.



MAINTENANCE FEE PAYMENT

Claimant Name: C William + Marcelline J. Nichols
 Address: 26134 N. 93rd Ave.
 City: Peoria State: AZ Zip: 85383
 Telephone: 623-376-8045
 E-mail address: mjcwnichols@msn.com
 Signature: Marcelline J. Nichols

Check here if this is a change of address.

RECEIVED
 PLM AZ STATE OFFICE
 2009 AUG 31 P 12:53
 PHOENIX, ARIZONA
 BLM
 Date
 Stamp

LINE NO.	AMC NUMBER	CLAIM/SITE NAME	COUNTY RECORDER DATA (If available)	TWP	RNG	SEC
1 ✓	384793	Estrella #1	2007-0821529	15	2W	31
2 ✓	384794	Estrella #2	2007-0821530	15	2W	31
3 ✓	384795	Estrella #3	2007-0821531	15	2W	31
4 ✓	384796	Estrella #4	2007-0821532	15	2W	31
5						
6						
7						
8						
9						
10						

List additional claims on Form MCF114.

Bureau of Land Management
Arizona State Office
 www.blm.gov/az/

No. of Claims: 4 x \$140 = 560.00
 Check No: 18467 Init. SC
 Receipt No.: 1992278
 For BLM Use Only

Form: MCF112
 Revised July 2009

This form is available from the Arizona Department of Mines and Mineral Resources and may be reproduced.

RECEIVED
 BLM AZ STATE OFFICE
 PHOENIX, ARIZONA
 2009 AUG 31 P 12:53

MAINTENANCE FEE PAYMENT

Claimant Name: C. William + Marcelline J. Nichols
 Address: 26134 N. 93rd Ave.
 City: Peoria State: AZ Zip: 85383
 Telephone: 623-376-8045
 E-mail address: mjcnichols@msn.com
 Signature: Marcelline Nichols

BLM
 Date
 Stamp

Check here if this is a change of address.

LINE NO.	AMC NUMBER	CLAIM/SITE NAME	COUNTY RECORDER DATA (If available)	TWP	RNG	SEC
1	384797	Hila Mountain #6	2007-0821533	25	4W	12
2	384798	Hila Mountain #7	2007-0821534	25	4W	12
3	384799	Hila Mountain #8	2007-0821535	25	4W	12
4	384800	Hila Mountain #9	2007-0821536	25	4W	12
5	384801	Hila Mountain #10	2007-0821537	25	4W	12
6	384802	Hila Mountain #11	2007-0821538	25	4W	13
7	384803	Hila Mountain #12	2007-0821539	25	4W	13
8	384804	Hila Mountain #13	2007-0821540	25	4W	13
9	384805	Hila Mountain #14	2007-0821541	25	4W	13
10	384806	Hila Mountain #15	2007-0821542	25	4W	13

List additional claims on Form MCF114.

Bureau of Land Management
 Arizona State Office
 www.blm.gov/az/

No. of Claims: 41 x \$140 = 5740.00
 Check No: 18467 Init. SC
 Receipt No.: 1992278
 For BLM Use Only

Form: MCF112
 Revised July 2009

This form is available from the Arizona Department of Mines and Mineral Resources and may be reproduced.

SUPPLEMENTAL ATTACHMENT

May be used with the following forms for listing additional mining claims:

Check One.

- Affidavit of Performance of Annual Work
- Maintenance Fee Payment
- Notice of Intent to Hold Mining Claims
- Notice of Non-Liability for Labor and Materials Furnished

RECEIVED
BLM STATE OFFICE
PHOENIX, ARIZONA
2009 AUG 31 P 12:53

BLM
Date
Stamp

LINE NO.	AMC NUMBER	CLAIM/SITE NAME	COUNTY RECORDER DATA (If available)	TWP	RNG	SEC
11	384807	Hila Mountain #16	2007-0821543	2S	4W	13
12	384808	Hila Mountain #17	2007-0821544	2S	4W	13
L 13	394491	Hila Mountain #18	2008-0734873	2S	4W	1
14	394492	Hila Mountain #19	2008-0734874	2S	4W	12
15	394493	Hila Mountain #20	2008-0734875	2S	4W	12
16	394494	Hila Mountain #21	2008-0734876	2S	4W	12
17	394495	Hila Mountain #22	2008-0734877	2S	4W	12
18	394496	Hila Mountain #23	2008-0734878	2S	4W	12
19	394497	Hila Mountain #24	2008-0734879	2S	4W	12
20	394498	Hila Mountain #25	2008-0734880	2S	4W	12
21	394499	Hila Mountain #26	2008-0734881	2S	4W	12
22	394500	Hila Mountain #27	2008-0734882	2S	4W	12
23	394501	Hila Mountain #28	2008-0734883	2S	4W	12
24	394502	Hila Mountain #29	2008-0734884	2S	4W	12
25	394503	Hila Mountain #30	2008-0734885	2S	4W	1
26	394504	Hila Mountain #31	2008-0734886	2S	4W	1
27	394505	Hila Mountain #32	2008-0734887	2S	4W	12
28	394506	Hila Mountain #33	2008-0734888	2S	4W	1
29	394507	Hila Mountain #34	2008-0734889	2S	4W	1

19/50

Form MCF114
Revised June 2005

This form is available from the Arizona Department of Mines & Mineral Resources and may be reproduced.

SUPPLEMENTAL ATTACHMENT

May be used with the following forms for listing additional mining claims:

Check One.

- Affidavit of Performance of Annual Work
- Maintenance Fee Payment
- Notice of Intent to Hold Mining Claims
- Notice of Non-Liability for Labor and Materials Furnished

RECEIVED
MARAZ STATE OFFICE
PHOENIX, ARIZONA
2009 AUG 31 P 12:53

BLM
Date
Stamp

LINE NO.	AMC NUMBER	CLAIM/SITE NAME	COUNTY RECORDER DATA (If available)	TWP	RNG	SEC
✓ 30	394508	Sila Mountain #35	2008-0734890	25	4W	1
31	394509	Sila Mountain #36	2008-0734891	25	4W	1
394510	394910	Sila Mountain #37	2008-0734892	25	4W	1
33	394511	Sila Mountain #38	2008-0734893	25	4W	1
✓ 34	394512	Sila Mountain #39	2008-0734894	25	4W	13
LV 35	394051	Sila Mountain #40	2008-0736836	25	3W	7
LV 36	394513	Sila Mountain #41	2008-0737568	25	4W	1
✓ 37	396284	Sila Mountain #42	2009-0214882	25	3W	6
38	396285	Sila Mountain #43	2009-0214883	25	3W	6
12/50 ✓ 39	397074	Sila Mountain #44	2009-0635328	25	3W	6
40	397075	Sila Mountain #45	2009-0635329	25	3W	6
41	397076	Sila Mountain #46	2009-0635330	25	3W	7
42						
43						
44						
45						
46						
47						
48						

Form MCF114
Revised June 2005

This form is available from the Arizona Department of Mines & Mineral Resources and may be reproduced.

United States Department of the Interior
Bureau of Land Management
 BUSINESS & SUPPORT SVCS DIV
 ONE N CENTRAL AVE SUITE 800
 PHOENIX, AZ 85004 -4427
 Phone: (602) 417-9200

Receipt

No: 1992278

Transaction #: 2056516	
Date of Transaction: 08/31/2009	
CUSTOMER:	CWILLIAMS NICHOLS 26134 N 93RD AVE PEORIA, AZ 85383-1350 US

LINE #	QTY	DESCRIPTION	REMARKS	UNIT PRICE	TOTAL
1	1.00	LOCATABLE MINERALS / MINING CLAIMS-NOT NEW-UNADJUD, ONE AUTH NO. ONLY / MINING CLAIM MONEY RECEIVED CASES: AMC384793/\$6440.00	MAINT (46) 2010	- n/a -	6440.00
TOTAL:					\$6,440.00

PAYMENT INFORMATION			
1	AMOUNT:	6440.00	POSTMARKED: N/A
	TYPE:	CHECK	RECEIVED: 08/31/2009
	CHECK NO:	18467	
	NAME:	NICHOLS, CWILLIAMS 26134 N 93RD AVE PEORIA AZ 85383-1350 US	

REMARKS

This receipt was generated by the automated BLM Collections and Billing System and is a paper representation of a portion of the official electronic record contained therein.

NOTICE!!

These documents have been scanned!

Do not place un-scanned documents beneath this notice!

Do not remove this notice from this file!

GPO Jacket No. 560-102
Print Order 61540
Rise Business Services, LLC
Job=AZ15 5/22/2019



Box Number= AZ15079



Claim Begin-End: AMC394513-AMC394513

5 Miscellaneous



AZ15079-5

AMC394407-AMC394878



Pauline
Brown/AZSO/AZ/BLM/DOI
08/26/2008 08:53 AM

To Sirita K Benally/AZSO/AZ/BLM/DOI@BLM, Tina Marie
Coladonato/AZSO/AZ/BLM/DOI@BLM, Susie
Cruz/AZSO/AZ/BLM/DOI@BLM, Eric
cc Amy Bunda/AZSO/AZ/BLM/DOI@BLM
bcc Bob Kritzstein/AZSO/AZ/BLM/DOI@BLM
Subject RECEIPT # 1769643 {NEED TO MOVE MONEY }

HERE IS YET ANOTHER TRANSACTION WHERE THE MONEY NEEDS TO BE
MOVED. THIS IS FOR AMC394513. PLEASE KEEP IN MIND THAT WHENEVER
EXTRA MAINTENANCE FEES ARE PAID, THE MONEY NEEDS TO BE CREDITED
TO **NOT NEW MONIES RECEIVED**, OTHERWISE IT WILL NOT EARN PROPERLY.

WHOEVER PROCESSED THIS TRANSACTION (#1827324) ON 08/25/2008; NEEDS
TO GO IN AND MOVE THE TOTAL AMOUNT OF \$125.00 {AMOUNT RECEIVED FOR
THE ADDITIONAL MAINTENANCE FEE PM'T} TO **NOT NEW MONIES RECEIVED**.

PAULINE BROWN
LEGAL INSTRUMENT EXAMINER
U.S. DEPARTMENT OF THE INTERIOR
BUREAU OF LAND MANAGEMENT
ONE NORTH CENTRAL AVE., SUITE 800
PHOENIX, ARIZONA 85004-4427
TEL: 602-417-9360; FAX: 602-417-9490
TTY: 602-417-9525
Pauline_Brown@blm.gov

Action Code Update

Serial-No: AMC394513

Status: ACTIVE

Bottom of Screen

ACTIONS SUCCESSFULLY SAVED WITH THE FOLLOWING WARNING(S):
Field: receipt_nr Occ: WARNING - RECEIPT NBR UNMATCHED OR INSUFFICIENT

	Del?	Date (mm/dd/yyyy)	Code	Action Taken	Action Remark	Receipt Nr	Ins I
<input checked="" type="radio"/> 1	<input checked="" type="checkbox"/>	08/20/2008	403	LOCATION DATE			P5BRC
<input type="radio"/> 2	<input checked="" type="checkbox"/>	08/25/2008	395	RECORDATION NOTICE RECD	1	1769643	CBS_II
<input type="radio"/> 3	<input checked="" type="checkbox"/>	08/25/2008	582	MAINTENANCE FEE/\$125	2009	1769643	P5BRC
<input type="radio"/> 4	<input checked="" type="checkbox"/>	08/25/2008	501	ACCT ADV IN LEAD FILE	AMC394513;		P5BRC
<input type="radio"/> 5	<input checked="" type="checkbox"/>	08/25/2008	484	LOCATION YEAR / MAINTENANCE FEE	2008	1769643	P5BRC

Actions: 5

Provide me with new occurrences

Please SAVE&CONTINUE Between DELETES and NEW/CHANGE Lines

Save & Continue

Save & Exit

Close

Lookup

Serial-No: AMC394513

Top of Screen

NOTICE!!

These documents have been scanned!

Do not place un-scanned documents beneath this notice!

Do not remove this notice from this file!

GPO Jacket No. 560-102
Print Order 61540
Rise Business Services, LLC
Job=AZ15 5/22/2019



Box Number= AZ15079



Claim Begin-End: AMC394513-AMC394513

6 Location Notices-Amendments and Supporting Documents



AZ15079-5 AMC394407-AMC394878

MINING CLAIM STATUS REPORT

DATA ENTRY _____

MTP CHECKED BY _____

GEO CHECKED BY _____

LEAD SERIAL NO. AMC 394513 THROUGH AMC

# _____	LODE	LOCATION FEE @ \$30 =	\$ <u>30</u>
# <u>1</u>	PLACER	PROCESSING FEE @ \$15 =	\$ <u>15</u>
# _____	ASSOCIATION PL	MAINTENANCE FEE @ \$125 =	\$ <u>250</u>
# _____	MILL SITE	OVERAGE	\$ _____
# _____	TUNNEL SITE	SHORTAGE	\$ _____
		OTHER FEES	\$ _____
		TOTAL	\$ _____

ENOUGH LOCATORS
YES [] NO [] _____

2007-2008 125
2008-2009 125

OVER-THE-COUNTER MAIL [] TIMELY FILED: YES NO []

LEGAL DESCRIPTION: T 02S R 04W SEC 001

T _____ R _____ SEC _____

T _____ R _____ SEC _____

T _____ R _____ SEC _____

BLM FOREST SERVICE [] _____ SUBJ TO PL 359: YES [] NO []

WILDERNESS AREA: NO [] YES [] _____

SPLIT ESTATE: SX [] PX [] SRHA [] OTHER [] _____ N/A []
PROPER NOTICE FILED IF LOCATED ON SRHA LANDS-YES [] NO [] N/A []

RECONVEYED MINERALS ON BLM LANDS REQUIRE OPENING ORDERS
FROM 1944 TO 1993. OPEN TO ENTRY ON: _____ N/A []

COMMENTS/STATUS: VOID [] PARTIALLY VOID [] PVT MINERALS []
WITHDRAWN LANDS [] OTHER [] _____

Claimant acknowledges that portions of the following claim(s) site(s) may be void or voidable. _____

Signature of claimant _____

FINAL ADJUDICATION RE DATE 1/14/16

Recordation Information:

WILLIAM NICHOLS
26134 N. 93 AVE
PEORIA AZ 85383

NOTICE OF MINING CLAIM LOCATION

1. TYPE OF NOTICE: Location Amendment Relocation

2. TYPE OF CLAIM OR SITE: Placer Lode Millsite Tunnel site

3. The name, address and telephone number of the name(s) to be considered owner(s) is
PLEASE PRINT (show additional owners on attached sheet)

Name: WILLIAM NICHOLS
Address: 26134 N. 93 AVE
City/State/Zip Code: PEORIA AZ 85383
Telephone Number (include area code): 623-376-8045

PHOENIX AZ

2008 AUG 25 A 11:37

RECEIVED
BLM. AZ STATE OFFICE

4. The name of the claim: GILA MOUNTAIN # 41

5. The date of location is: 8-20-2008

6. The claim is 1320 feet long and 1320 feet wide. The distance from the location monument to each end of the claim is 1320 feet in a EAST direction and 1320 feet in a NORTH direction.

7. The SW corner of the claim is 1320'

from a survey monument or permanent natural object described as Quarter section marker (survey monument) on sec 1 + 12, T2S, R4W

8. The general course of the claim is from the _____ to the _____

9. The location of the claim is in Section(s) 1, Quarter Section(s) SW, Township(s) 2S, Range(s) 4W, Gila and Salt River Meridian, Maricopa County, State of Arizona.

10. Is the claim filed under Public Law 359? yes no

11. Monument types are 4" PVC

Date 8/25/2008 Signature William Nichols

Locator
 Agent Only

AMB 2008513

MAP OF MINING CLAIM LOCATION

1. The name of the claim is Gila Mountain # 41
2. The SW corner of the claim is 1320 feet in a West direction to a survey monument or permanent object as described as Quarter section survey monument for sections 1+12, T2S, R4W
3. The type of location monument is 4" PVC
4. The bearing and distance between the corners of the claim are beginning at the SW corner of the claim, 1320 feet in a North direction to the NW corner, then 1320 feet in a East direction to the NE corner, then 1320 feet in a South direction to the SE corner, then 1320 feet in a West direction to the point of beginning.
5. Please indicate the distance and bearings between claim corners and a recognized survey monument or landmark. Indicate the distance from the location monument to each end of the claim.

MAP

One Inch = One Thousand Feet

North Arrow



One Mile

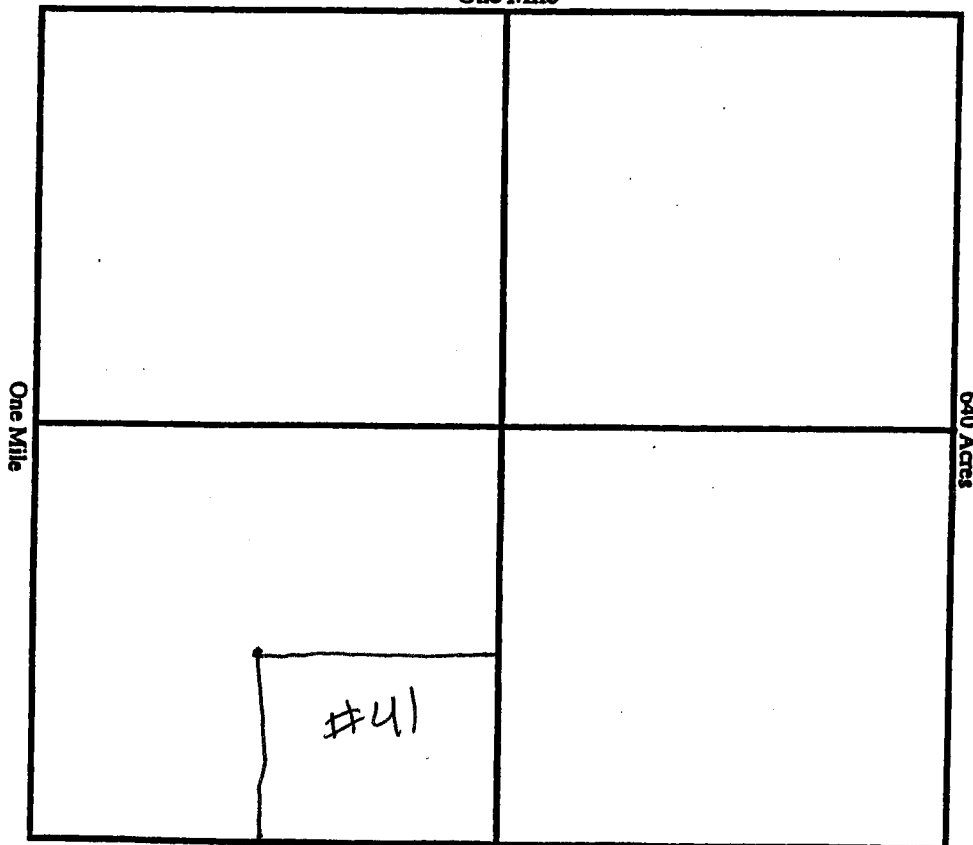

Section 1 Quarter Section SW Range 4W
 Township 2S G&SR Meridian, Maricopa County, Arizona.

Date 8-25-2008

Signature Chim Nishler

CLAIM NAME Good Mountain #41

Additional Owners:

Name: MARCI L I N E J. N I C H O L S
Address: 26134 N 93 ave
City/State/Zip Code: Peoria Az 85383
Telephone Number (area code): 623-376 8045

Name: _____
Address: _____
City/State/Zip Code: _____
Telephone Number (area code): _____

Name: _____
Address: _____
City/State/Zip Code: _____
Telephone Number (area code): _____

Name: _____
Address: _____
City/State/Zip Code: _____
Telephone Number (area code): _____

Name: _____
Address: _____
City/State/Zip Code: _____
Telephone Number (area code): _____

Name: _____
Address: _____
City/State/Zip Code: _____
Telephone Number (area code): _____

Name: _____
Address: _____
City/State/Zip Code: _____
Telephone Number (area code): _____

RECEIVED
BLM. AZ STATE OFFICE
2008 AUG 25 A 11:36
PHOENIX, AZ

AMS 304513

DEPARTMENT OF INTERIOR
BUREAU OF LAND MANAGEMENT

Input Parameters for Geographic Report with Land

System Id = CR

Admin State = AZ

Geo State = AZ

Casetype Begins With

Case Disp Txt = AUTHORIZED, CANCELLED, EXPIRED, PENDING, REJECTED, RELINQUISHED, WITHDRAWN

Mer Twp Rng = 14 0020S 0040W

Section = 001

Mtrs =

Commodity =

Commodity Txt =

Pending Org =

Pend Org Decode =

Total Rows Returned: 9

RUN TIME: 08:56 AM

Adm State: AZ

UNITED STATES DEPARTMENT OF INTERIOR
BUREAU OF LAND MANAGEMENT
GEOGRAPHIC REPORT WITH LAND
Sorted by Meridian Township Range

RUN DATE: 08/26/2008
Page 1 of 2

Serial Number: AZA 011068

Total Case Acres: 6.940

<u>Casetype</u>	<u>Case Disp</u>	14	0020S	0040W	<u>Sect</u>	<u>Sur Typ</u>	<u>Sur Num</u>	<u>Suff</u>	<u>Subdivision</u>	<u>Act Pend</u>
286203	AUTHORIZED				001	LOTS			5,8,9,12;	

Serial Number: AZA 032782

Total Case Acres: 227.290

<u>Casetype</u>	<u>Case Disp</u>	14	0020S	0040W	<u>Sect</u>	<u>Sur Typ</u>	<u>Sur Num</u>	<u>Suff</u>	<u>Subdivision</u>	<u>Act Pend</u>
282103	AUTHORIZED				001	ALIQ LOTS			SENW; 3,5,8,9,12;	

Serial Number: AZA 032903

Total Case Acres: 160.000

<u>Casetype</u>	<u>Case Disp</u>	14	0020S	0040W	<u>Sect</u>	<u>Sur Typ</u>	<u>Sur Num</u>	<u>Suff</u>	<u>Subdivision</u>	<u>Act Pend</u>
361113	AUTHORIZED				001	FF			PART;	

Serial Number: AZA 032921

Total Case Acres: 1.000

<u>Casetype</u>	<u>Case Disp</u>	14	0020S	0040W	<u>Sect</u>	<u>Sur Typ</u>	<u>Sur Num</u>	<u>Suff</u>	<u>Subdivision</u>	<u>Act Pend</u>
360213	EXPIRED				001	MNR			SESWSE;	

Serial Number: AZAR 0005377

Total Case Acres: 193.000

<u>Casetype</u>	<u>Case Disp</u>	14	0020S	0040W	<u>Sect</u>	<u>Sur Typ</u>	<u>Sur Num</u>	<u>Suff</u>	<u>Subdivision</u>	<u>Act Pend</u>
282105	AUTHORIZED				001	LOTS			5-8,9-12;	

RUN TIME: 08:56 AM

Adm State: AZ

UNITED STATES DEPARTMENT OF INTERIOR
BUREAU OF LAND MANAGEMENT
GEOGRAPHIC REPORT WITH LAND
Sorted by Meridian Township Range

RUN DATE: 08/26/2008
Page 2 of 2

Serial Number: AZAR 0032095

Total Case Acres: 5.378

<u>Casetype</u>	<u>Case Disp</u>				<u>Sect</u>	<u>Sur Typ</u>	<u>Sur Num</u>	<u>Suff</u>	<u>Subdivision</u>	<u>Act Pend</u>
286202	AUTHORIZED	14	0020S	0040W	001	ALIQ LOTS			SWNW,W2SW; 4;	

Serial Number: AZAR 0032193B2

Total Case Acres: 262.960

<u>Casetype</u>	<u>Case Disp</u>				<u>Sect</u>	<u>Sur Typ</u>	<u>Sur Num</u>	<u>Suff</u>	<u>Subdivision</u>	<u>Act Pend</u>
274000	AUTHORIZED	14	0020S	0040W	001	LOTS			6,7,10,11;	

